





## Wedding Bands

---

384 Precious Metal

434 Contemporary Metal



CHOOSE  
CHANGE  
CREATE

*Shown above: 50075  
For product information, visit [stuller.com](http://stuller.com).*

## BAND PROFILES

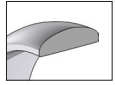

**HR** Half Round: *Flat surface against the finger, domed surface away from the finger*

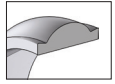

**HRE** Half Round Edge: *Flat surface against the finger, domed surface away from the finger, with narrow polished edges*

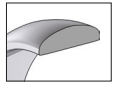

**HRT** Half Round Tapered: *Flat surface against the finger, domed surface away from the finger, tapering to approximately half the width of the top*

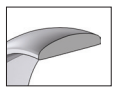

**HRL** Half Round Light: *Flat against the finger, domed away from the finger, thickness approximately 70% of HR*

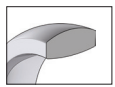

**IR** Inside Round: *Also called Comfort Fit; rounded surface against the finger, domed surface away from the finger*

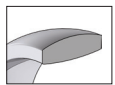

**IRL** Inside Round Light: *Also called Comfort Fit Light, rounded against the finger, domed away from the finger, thickness approximately 70% of Inside Round*

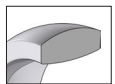

**IRH** Inside Round Heavy: *Also called Comfort Fit Heavy, rounded surface against the finger, domed surface away from the finger, thickness approximately 15% greater than IR*

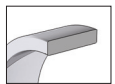

**F** Flat: *Flat against the finger, flat away from the finger*

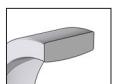

**FIR** Flat Comfort Fit: *Rounded surface against the finger, flat surface away from the finger*

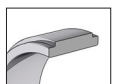

**FE** Flat Edge: *Flat surface against the finger, flat surface away from the finger, with narrow polished edges*

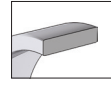

**FT** Flat Tapered: *Flat surface against the finger, flat surface away from the finger, tapering to approximately half the width of the top*

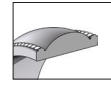

**MG** Milgrain: *Flat surface against the finger, domed surface away from the finger, with narrow beaded edges*

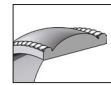

**MGR** Milgrain Comfort Fit: *Rounded surface against the finger, domed surface away from the finger, with narrow beaded edges*

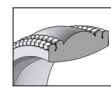

**DMGR** Double Milgrain Comfort Fit: *Rounded surface against the finger, domed surface away from the finger, with double beaded edges*

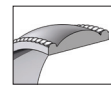

**MGL** Milgrain Light: *Flat surface against the finger, domed surface away from the finger, with narrow beaded edges, averages 72% as thick as Milgrain*

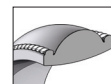

**MGRL** Milgrain Comfort Fit Light: *Rounded surface against the finger, domed surface away from the finger, with narrow beaded edges, averages 84% as thick as Milgrain Comfort Fit*

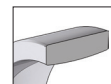

**SQR** Square Comfort Fit: *Rounded surface against the finger, soft square exterior shape*

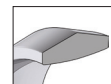

**KER** Knife Edge Comfort Fit: *Rounded surface against the finger, 2-sided peaked surface away from the finger*

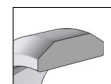

**Octagon:** *Flat against the finger, eight equal sides away from the finger*

## Engraving

Add a personal message on a gift. It can be engraved by laser or machine, or you can choose to upload a customer's own handwritten message. Six color fill options are also available with laser engraving and handwritten engraving only.

### Cost of Engraving

Font Engraving	\$15-\$50
Handwritten	\$30
Color Fill	\$10
All Others	\$50

### Engraving Styles

Bookman Old Style

*Lucida Handwriting*

**Old English**

Your Own Handwritten Message

*Script MT Bold*

Colonna MT

*Edwardian Script*

### Fill Colors

BLACK GREEN BLUE

PINK BROWN RED

\*Fill colors available with laser engraving and handwritten engraving only.

## Special Finishes

Make a customer's band unique by adding a special finish to the outside. Seven different finishes are available and can be ready in time for two-day delivery.

### Cost of Special Finishes

Hammer	\$60
Florentine	\$80
All Others	\$50



Bead Blast / Matte

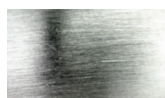

Satin / Brushed



Stone



Glass Blast

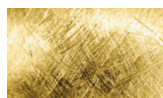

Ice



Florentine



Hammered

\*Not all options are offered on all bands. See product sections on stuller.com for additional info.

## Laser Patterns

Apply a laser pattern that fits your customer's style and personality to the outside of a band. Choose from more than 30 patterns that can be ready in time for three-day delivery.

### Cost of Laser Patterns

\$30



Tiger



Jaguar



Giraffe



Tribal



Barbed Wire



Mokume



Tread

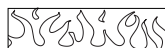

Flame



DNA



Greek Key



Celtic Knot



Interlocking Circles

\*See stuller.com for complete selection of laser patterns. Not available on contemporary metal bands.

These options can be requested when you order select wedding bands. All are considered special orders and cannot be canceled or returned.

Most items available in any metal quality.

Suggested retail prices based on \$1,600 gold, \$1,700 platinum and \$30 silver. Visit [stuller.com](http://stuller.com) for our complete product selections and current pricing. | 385

# HALF-ROUND BANDS

**HR**

## Half Round

Flat surface against the finger,  
domed surface away from the finger.

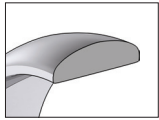

cross sectional view



### Available Widths



2mm



2.5mm



3mm



4mm



5mm



6mm



7mm



8mm



10mm



12mm

### Available Finger Sizes

4 | 4.5 | 5 | 5.5 | 6 | 6.5 | 7 | 7.5 | 8 | 8.5 | 9 | 9.5 | 10 | 10.5 | 11 | 11.5 | 12 | 12.5 | 13 | 13.5 | 14 | 14.5 | 15 | 15.5

### Special Finishes



Bead Blast / Matte



Ice



Florentine

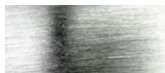

Satin / Brushed



Glass Blast



Stone



Hammered

### Available Metal Qualities



**Platinum**  
950



**Continuum™**  
Sterling Silver



**White Gold**  
10kt  
14kt  
18kt  
14kt X1



**Sterling Silver**



**Yellow Gold**  
10kt  
14kt  
18kt



**Palladium**



**Rose Gold**  
10kt  
14kt  
18kt

### Engraving

Engrave a message for \$30 per location. Add a color fill for \$10. Use your own handwriting or choose from:

Bookman Old Style  
Lucida Handwriting  
**Old English**  
**Script MT Bold**  
Colonna MT  
*Edwardian Script*

See **page 385** for engraving and special finish details.

2mm

Finger Size	\$1,700 Platinum	\$1,600 14kt Gold	\$1,600 10kt Gold
4	\$625	\$225	\$165
5	\$649	\$229	\$169
6	\$675	\$239	\$175
7	\$705	\$249	\$179
8	\$735	\$259	\$185
9	\$759	\$269	\$195
10	\$785	\$279	\$199
11	\$815	\$285	\$205
12	\$839	\$295	\$215
13	\$865	\$305	\$219
14	\$939	\$315	\$229
15	\$1,005	\$325	\$235

2.5mm

Finger Size	\$1,700 Platinum	\$1,600 14kt Gold	\$1,600 10kt Gold
4	\$745	\$265	\$195
5	\$775	\$275	\$199
6	\$809	\$289	\$205
7	\$845	\$299	\$215
8	\$879	\$309	\$225
9	\$915	\$325	\$229
10	\$949	\$335	\$239
11	\$999	\$345	\$245
12	\$1,015	\$359	\$255
13	\$1,065	\$369	\$275
14	\$1,135	\$379	\$275
15	\$1,219	\$395	\$279

3mm

Finger Size	\$1,700 Platinum	\$1,600 14kt Gold	\$1,600 10kt Gold
4	\$835	\$289	\$205
5	\$875	\$305	\$209
6	\$915	\$315	\$225
7	\$955	\$329	\$239
8	\$995	\$345	\$239
9	\$1,035	\$355	\$255
10	\$1,075	\$365	\$255
11	\$1,115	\$379	\$265
12	\$1,155	\$395	\$275
13	\$1,155	\$405	\$295
14	\$1,245	\$419	\$299
15	\$1,339	\$429	\$305

4mm

Finger Size	\$1,700 Platinum	\$1,600 14kt Gold	\$1,600 10kt Gold
4	\$1,245	\$439	\$315
5	\$1,305	\$465	\$325
6	\$1,365	\$485	\$345
7	\$1,425	\$505	\$355
8	\$1,485	\$525	\$369
9	\$1,545	\$545	\$385
10	\$1,609	\$565	\$399
11	\$1,665	\$589	\$415
12	\$1,725	\$609	\$429
13	\$1,815	\$629	\$445
14	\$1,945	\$649	\$455
15	\$2,089	\$675	\$475

5mm

Finger Size	\$1,700 Platinum	\$1,600 14kt Gold	\$1,600 10kt Gold
4	\$1,515	\$535	\$379
5	\$1,589	\$565	\$395
6	\$1,665	\$589	\$415
7	\$1,745	\$615	\$435
8	\$1,819	\$639	\$449
9	\$1,895	\$665	\$469
10	\$1,975	\$695	\$485
11	\$2,049	\$719	\$505
12	\$2,125	\$745	\$525
13	\$2,239	\$769	\$539
14	\$2,395	\$795	\$555
15	\$2,579	\$825	\$575

6mm

Finger Size	\$1,700 Platinum	\$1,600 14kt Gold	\$1,600 10kt Gold
4	\$1,739	\$619	\$435
5	\$1,829	\$649	\$455
6	\$1,915	\$679	\$479
7	\$2,005	\$709	\$499
8	\$2,095	\$739	\$519
9	\$2,179	\$769	\$539
10	\$2,265	\$799	\$559
11	\$2,349	\$829	\$579
12	\$2,439	\$855	\$599
13	\$2,569	\$885	\$619
14	\$2,615	\$915	\$639
15	\$2,959	\$945	\$659

7mm

Finger Size	\$1,700 Platinum	\$1,600 14kt Gold	\$1,600 10kt Gold
4	\$2,005	\$729	\$509
5	\$2,115	\$765	\$535
6	\$2,219	\$795	\$555
7	\$2,329	\$829	\$579
8	\$2,435	\$865	\$605
9	\$2,545	\$899	\$629
10	\$2,655	\$935	\$655
11	\$2,759	\$995	\$675
12	\$2,869	\$1,005	\$699
13	\$3,029	\$1,035	\$725
14	\$3,085	\$1,069	\$745
15	\$3,189	\$1,105	\$769

8mm

Finger Size	\$1,700 Platinum	\$1,600 14kt Gold	\$1,600 10kt Gold
4	\$2,249	\$819	\$575
5	\$2,365	\$859	\$605
6	\$2,479	\$905	\$629
7	\$2,599	\$945	\$659
8	\$2,715	\$985	\$689
9	\$2,835	\$1,025	\$719
10	\$2,949	\$1,069	\$745
11	\$3,065	\$1,109	\$775
12	\$3,185	\$1,155	\$805
13	\$3,359	\$1,195	\$835
14	\$3,419	\$1,235	\$859
15	\$3,879	\$1,275	\$889

10mm

Finger Size	\$1,700 Platinum	\$1,600 14kt Gold	\$1,600 10kt Gold
4	\$2,735	\$995	\$695
5	\$2,869	\$1,045	\$729
6	\$3,005	\$1,009	\$765
7	\$3,139	\$1,149	\$799
8	\$3,275	\$1,199	\$835
9	\$3,415	\$1,249	\$875
10	\$3,549	\$1,305	\$909
11	\$3,685	\$1,355	\$945
12	\$3,819	\$1,405	\$979
13	\$4,025	\$1,455	\$1,015
14	\$4,305	\$1,505	\$1,049
15	\$4,625	\$1,559	\$1,085

12mm

Finger Size	\$1,700 Platinum	\$1,600 14kt Gold	\$1,600 10kt Gold
4	\$3,575	\$1,299	\$905
5	\$3,765	\$1,365	\$949
6	\$3,949	\$1,429	\$995
7	\$4,139	\$1,495	\$1,039

Finger Size	\$1,700 Platinum	\$1,600 14kt Gold	\$1,600 10kt Gold
8	\$4,329	\$1,559	\$1,085
9	\$4,515	\$1,625	\$1,129
10	\$4,705	\$1,689	\$1,175
11	\$4,895	\$1,755	\$1,219

Finger Size	\$1,700 Platinum	\$1,600 14kt Gold	\$1,600 10kt Gold
12	\$5,079	\$1,819	\$1,265
13	\$5,269	\$1,885	\$1,309
14	\$5,459	\$1,949	\$1,355
15	\$5,645	\$2,015	\$1,399

Most items available in any metal quality.

Suggested retail prices based on \$1,600 gold, \$1,700 platinum and \$30 silver. Visit [stuller.com](http://stuller.com) for our complete product selections and current pricing. | 387

# HALF ROUND BANDS

**HRL**

## Half Round Light

Flat against the finger, domed away from the finger, thickness approximately 70% of HR.

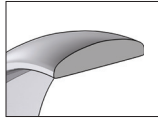

cross sectional view



### Available Widths



2mm



2.5mm



3mm



4mm



5mm



6mm



7mm



8mm

### Available Finger Sizes

4 | 4.5 | 5 | 5.5 | 6 | 6.5 | 7 | 7.5 | 8 | 8.5 | 9 | 9.5 | 10 | 10.5 | 11 | 11.5 | 12 | 12.5 | 13 | 13.5 | 14 | 14.5 | 15 | 15.5

### Special Finishes



Bead Blast / Matte



Ice



Florentine

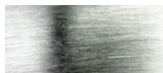

Satin / Brushed



Glass Blast



Stone



Hammered

### Available Metal Qualities



**Platinum  
950**



**Continuum™  
Sterling Silver**



**White Gold**  
10kt  
14kt  
18kt  
14kt X1



**Sterling Silver**



**Palladium**



**Yellow Gold**  
10kt  
14kt  
18kt



**Rose Gold**  
10kt  
14kt  
18kt

### Engraving

Engrave a message for \$30 per location. Add a color fill for \$10. Use your own handwriting or choose from:

Bookman Old Style  
*Lucida Handwriting*  
**Old English**  
*Script MT Bold*  
Colonna MT  
*Edwardian Script*

See **page 385** for engraving and special finish details.

2mm

Finger Size	\$1,700 Platinum	\$1,600 14kt Gold	\$1,600 10kt Gold
4	\$499	\$189	\$139
5	\$515	\$199	\$145
6	\$579	\$209	\$149
7	\$555	\$215	\$155
8	\$569	\$225	\$165
9	\$589	\$235	\$169
10	\$605	\$245	\$175
11	\$625	\$249	\$179
12	\$645	\$259	\$185
13	\$659	\$269	\$195
14	\$679	\$275	\$199
15	\$695	\$285	\$205

2.5mm

Finger Size	\$1,700 Platinum	\$1,600 14kt Gold	\$1,600 10kt Gold
4	\$745	\$225	\$165
5	\$619	\$235	\$169
6	\$645	\$245	\$179
7	\$675	\$255	\$185
8	\$699	\$265	\$195
9	\$725	\$275	\$199
10	\$755	\$285	\$205
11	\$779	\$295	\$215
12	\$805	\$305	\$219
13	\$829	\$315	\$225
14	\$855	\$325	\$235
15	\$879	\$335	\$239

3mm

Finger Size	\$1,700 Platinum	\$1,600 14kt Gold	\$1,600 10kt Gold
4	\$669	\$259	\$185
5	\$705	\$269	\$195
6	\$745	\$285	\$205
7	\$785	\$295	\$215
8	\$819	\$309	\$219
9	\$855	\$319	\$229
10	\$895	\$335	\$239
11	\$929	\$345	\$245
12	\$965	\$355	\$255
13	\$1,005	\$369	\$265
14	\$1,045	\$385	\$269
15	\$1,079	\$395	\$279

4mm

Finger Size	\$1,700 Platinum	\$1,600 14kt Gold	\$1,600 10kt Gold
4	\$929	\$339	\$245
5	\$975	\$355	\$255
6	\$1,015	\$375	\$265
7	\$1,065	\$389	\$275
8	\$1,105	\$405	\$289
9	\$1,149	\$425	\$299
10	\$1,195	\$439	\$315
11	\$1,239	\$455	\$325
12	\$1,285	\$475	\$335
13	\$1,329	\$489	\$345
14	\$1,375	\$505	\$359
15	\$1,419	\$525	\$369

5mm

Finger Size	\$1,700 Platinum	\$1,600 14kt Gold	\$1,600 10kt Gold
4	\$1,125	\$409	\$295
5	\$1,179	\$429	\$305
6	\$1,235	\$449	\$319
7	\$1,289	\$469	\$335
8	\$1,345	\$489	\$349
9	\$1,405	\$509	\$359
10	\$1,459	\$529	\$375
11	\$1,515	\$549	\$389
12	\$1,569	\$569	\$399
13	\$1,625	\$589	\$415
14	\$1,679	\$609	\$429
15	\$1,735	\$629	\$445

6mm

Finger Size	\$1,700 Platinum	\$1,600 14kt Gold	\$1,600 10kt Gold
4	\$1,335	\$485	\$345
5	\$1,405	\$515	\$359
6	\$1,475	\$535	\$379
7	\$1,539	\$565	\$395
8	\$1,609	\$585	\$415
9	\$1,675	\$615	\$429
10	\$1,745	\$635	\$449
11	\$1,815	\$665	\$465
12	\$1,885	\$685	\$485
13	\$1,955	\$709	\$499
14	\$2,019	\$735	\$515
15	\$2,089	\$759	\$535

7mm

Finger Size	\$1,700 Platinum	\$1,600 14kt Gold	\$1,600 10kt Gold
4	\$1,529	\$559	\$395
5	\$1,605	\$589	\$415
6	\$1,679	\$615	\$435
7	\$1,775	\$645	\$455
8	\$1,835	\$669	\$469
9	\$1,909	\$695	\$489
10	\$1,985	\$725	\$509
11	\$2,065	\$755	\$525
12	\$2,139	\$779	\$545
13	\$2,215	\$805	\$565
14	\$2,289	\$835	\$585
15	\$2,365	\$859	\$605

8mm

Finger Size	\$1,700 Platinum	\$1,600 14kt Gold	\$1,600 10kt Gold
4	\$1,715	\$635	\$445
5	\$1,809	\$665	\$465
6	\$1,905	\$695	\$489
7	\$1,995	\$725	\$509
8	\$2,085	\$755	\$529
9	\$2,179	\$789	\$555
10	\$2,269	\$819	\$575
11	\$2,365	\$849	\$595
12	\$2,455	\$885	\$615
13	\$2,545	\$915	\$639
14	\$2,639	\$945	\$659
15	\$2,735	\$975	\$685



# HALF ROUND BANDS



**HRT**

## Half Round Tapered

Flat surface against the finger, domed surface away from the finger, tapering to approximately half the width of the top.

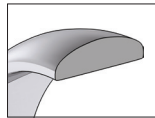

cross sectional view

### Available Widths



**HRE**

## Half Round Edge

Flat surface against the finger, domed surface away from the finger, with narrow polished edges.

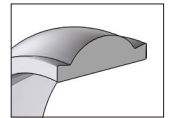

cross sectional view

### Available Widths



### Available Finger Sizes

4 | 4.5 | 5 | 5.5 | 6 | 6.5 | 7 | 7.5 | 8 | 8.5 | 9 | 9.5 | 10 | 10.5 | 11 | 11.5 | 12 | 12.5 | 13 | 13.5 | 14 | 14.5 | 15 | 15.5

### Available Metal Qualities



**Platinum**  
950



**Continuum™**  
Sterling Silver



**White Gold**  
10kt  
14kt  
18kt  
14kt X1



**Sterling Silver**



**Palladium**



**Yellow Gold**  
10kt  
14kt  
18kt



**Rose Gold**  
10kt  
14kt  
18kt

### Engraving

Engrave a message for \$30 per location. Add a color fill for \$10. Use your own handwriting or choose from:

Bookman Old Style  
*Lucida Handwriting*  
**Old English**  
*Script MS Bold*  
Colonna MT  
*Edwardian Script*

See **page 385** for engraving and special finish details.

**HRT**

**2.5mm**

Finger Size	\$1,700 Platinum	\$1,600 14kt Gold	\$1,600 10kt Gold
6	\$695	\$259	\$195
10	\$789	\$279	\$205

**3mm**

Finger Size	\$1,700 Platinum	\$1,600 14kt Gold	\$1,600 10kt Gold
6	\$785	\$285	\$209
10	\$889	\$345	\$249

**4mm**

Finger Size	\$1,700 Platinum	\$1,600 14kt Gold	\$1,600 10kt Gold
6	\$935	\$345	\$249
10	\$1,089	\$415	\$299

**5mm**

Finger Size	\$1,700 Platinum	\$1,600 14kt Gold	\$1,600 10kt Gold
6	\$1,175	\$445	\$319
10	\$1,335	\$515	\$365

**6mm**

Finger Size	\$1,700 Platinum	\$1,600 14kt Gold	\$1,600 10kt Gold
6	\$1,365	\$489	\$349
10	\$1,515	\$589	\$419

**8mm**

Finger Size	\$1,700 Platinum	\$1,600 14kt Gold	\$1,600 10kt Gold
6	\$1,709	\$629	\$449
10	\$2,065	\$759	\$535

**HRE**

**2mm**

Finger Size	\$1,700 Platinum	\$1,600 14kt Gold	\$1,600 10kt Gold
4	\$545	\$199	\$165
5	\$555	\$225	\$169
6	\$675	\$235	\$175
7	\$519	\$245	\$179
8	\$679	\$249	\$185
9	\$705	\$259	\$195
10	\$705	\$269	\$199
11	\$725	\$275	\$205
12	\$815	\$285	\$209
13	\$849	\$295	\$215
14	\$889	\$305	\$225
15	\$925	\$315	\$229

**2.5mm**

Finger Size	\$1,700 Platinum	\$1,600 14kt Gold	\$1,600 10kt Gold
4	\$669	\$259	\$195
5	\$685	\$269	\$199
6	\$755	\$285	\$209
7	\$769	\$295	\$215
8	\$829	\$305	\$225
9	\$855	\$315	\$235
10	\$865	\$325	\$239
11	\$899	\$339	\$245
12	\$969	\$349	\$255
13	\$1,009	\$359	\$265
14	\$1,049	\$375	\$269
15	\$1,085	\$385	\$279

**3mm**

Finger Size	\$1,700 Platinum	\$1,600 14kt Gold	\$1,600 10kt Gold
4	\$669	\$315	\$229
5	\$885	\$329	\$239
6	\$919	\$345	\$249
7	\$939	\$355	\$259
8	\$1,059	\$369	\$269
9	\$1,005	\$385	\$275
10	\$1,049	\$395	\$285
11	\$1,085	\$409	\$295
12	\$1,139	\$425	\$305
13	\$1,165	\$435	\$315
14	\$1,199	\$449	\$325
15	\$1,245	\$465	\$335

**4mm**

Finger Size	\$1,700 Platinum	\$1,600 14kt Gold	\$1,600 10kt Gold
4	\$1,059	\$429	\$339
5	\$1,195	\$449	\$325
6	\$1,265	\$465	\$335
7	\$1,279	\$485	\$349
8	\$1,305	\$505	\$365
9	\$1,439	\$525	\$379
10	\$1,515	\$545	\$389
11	\$1,525	\$565	\$405
12	\$1,585	\$585	\$419
13	\$1,645	\$605	\$425
14	\$1,689	\$625	\$445
15	\$1,539	\$645	\$459

**5mm**

Finger Size	\$1,700 Platinum	\$1,600 14kt Gold	\$1,600 10kt Gold
4	\$1,465	\$545	\$389
5	\$1,519	\$575	\$409
6	\$1,619	\$605	\$429
7	\$1,699	\$629	\$449
8	\$1,735	\$659	\$465
9	\$1,799	\$685	\$485
10	\$1,985	\$715	\$505
11	\$1,935	\$745	\$525
12	\$2,055	\$769	\$545
13	\$2,155	\$799	\$565
14	\$2,225	\$825	\$585
15	\$2,265	\$855	\$605

**6mm**

Finger Size	\$1,700 Platinum	\$1,600 14kt Gold	\$1,600 10kt Gold
4	\$1,835	\$695	\$495
5	\$1,935	\$729	\$515
6	\$2,089	\$759	\$539
7	\$2,139	\$789	\$559
8	\$2,285	\$825	\$579
9	\$2,255	\$855	\$605
10	\$2,329	\$885	\$625
11	\$2,399	\$919	\$645
12	\$2,575	\$949	\$669
13	\$2,665	\$979	\$689
14	\$2,505	\$1,015	\$715
15	\$2,779	\$1,045	\$735

**8mm**

Finger Size	\$1,700 Platinum	\$1,600 14kt Gold	\$1,600 10kt Gold
4	\$2,745	\$1,009	\$715
5	\$2,875	\$1,055	\$745
6	\$2,875	\$1,105	\$775
7	\$3,145	\$1,155	\$809

Finger Size	\$1,700 Platinum	\$1,600 14kt Gold	\$1,600 10kt Gold
8	\$2,609	\$1,199	\$845
9	\$3,415	\$1,245	\$875
10	\$3,605	\$1,295	\$905
11	\$3,645	\$1,339	\$939

Finger Size	\$1,700 Platinum	\$1,600 14kt Gold	\$1,600 10kt Gold
12	\$3,749	\$1,389	\$975
13	\$3,939	\$1,435	\$1,005
14	\$3,915	\$1,485	\$1,039
15	\$4,125	\$1,529	\$1,069

Most items available in any metal quality.

Suggested retail prices based on \$1,600 gold, \$1,700 platinum and \$30 silver. Visit [stuller.com](http://stuller.com) for our complete product selections and current pricing. | 391

MG

**Milgrain**

Flat surface against the finger, domed surface away from the finger, with narrow beaded edges.

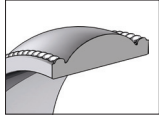

cross sectional view



**Available Widths**



2.5mm



3mm



4mm



5mm



6mm



8mm

**Available Finger Sizes**

4 | 4.5 | 5 | 5.5 | 6 | 6.5 | 7 | 7.5 | 8 | 8.5 | 9 | 9.5 | 10 | 10.5 | 11 | 11.5 | 12 | 12.5 | 13 | 13.5 | 14 | 14.5 | 15 | 15.5

**Special Finishes**



Bead Blast / Matte



Glass Blast



Ice

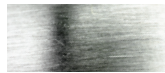

Satin / Brushed

**Available Metal Qualities**



**Platinum**  
950



**Continuum™**  
Sterling Silver



**White Gold**  
10kt  
14kt  
18kt  
14kt X1



**Sterling Silver**



**Yellow Gold**  
10kt  
14kt  
18kt



**Palladium**



**Rose Gold**  
10kt  
14kt  
18kt

**Engraving**

Engrave a message for \$30 per location. Add a color fill for \$10. Use your own handwriting or choose from:

- Bookman Old Style
- Lucida Handwriting
- Old English
- Script MT Bold
- Colonna MT
- Edwardian Script

See **page 385** for engraving and special finish details.

**2.5mm**

Finger Size	\$1,700 Platinum	\$1,600 14kt Gold	\$1,600 10kt Gold
4	\$705	\$265	\$199
5	\$675	\$275	\$205
6	\$715	\$285	\$209
7	\$759	\$295	\$219
8	\$799	\$305	\$225
9	\$839	\$315	\$229
10	\$885	\$325	\$239
11	\$925	\$335	\$245
12	\$969	\$339	\$249
13	\$1,015	\$349	\$259
14	\$1,055	\$359	\$265
15	\$1,099	\$369	\$269

**3mm**

Finger Size	\$1,700 Platinum	\$1,600 14kt Gold	\$1,600 10kt Gold
4	\$799	\$315	\$229
5	\$885	\$329	\$239
6	\$865	\$345	\$255
7	\$895	\$359	\$265
8	\$929	\$375	\$275
9	\$965	\$389	\$285
10	\$995	\$405	\$295
11	\$1,025	\$419	\$305
12	\$1,059	\$435	\$315
13	\$1,095	\$449	\$325
14	\$1,125	\$465	\$335
15	\$1,155	\$479	\$345

**4mm**

Finger Size	\$1,700 Platinum	\$1,600 14kt Gold	\$1,600 10kt Gold
4	\$1,105	\$435	\$315
5	\$1,155	\$449	\$325
6	\$1,205	\$469	\$339
7	\$1,255	\$489	\$355
8	\$1,305	\$509	\$365
9	\$1,355	\$529	\$379
10	\$1,409	\$549	\$395
11	\$1,459	\$565	\$405
12	\$1,509	\$589	\$419
13	\$1,555	\$609	\$435
14	\$1,605	\$625	\$449
15	\$1,655	\$645	\$459

**5mm**

Finger Size	\$1,700 Platinum	\$1,600 14kt Gold	\$1,600 10kt Gold
4	\$1,429	\$559	\$405
5	\$1,499	\$585	\$419
6	\$1,569	\$615	\$435
7	\$1,639	\$635	\$455
8	\$1,715	\$659	\$469
9	\$1,785	\$685	\$485
10	\$1,855	\$709	\$505
11	\$1,925	\$735	\$519
12	\$1,999	\$755	\$539
13	\$2,069	\$779	\$555
14	\$2,139	\$805	\$575
15	\$2,209	\$829	\$589

**6mm**

Finger Size	\$1,700 Platinum	\$1,600 14kt Gold	\$1,600 10kt Gold
4	\$1,815	\$705	\$499
5	\$1,905	\$729	\$519
6	\$1,995	\$765	\$539
7	\$2,085	\$795	\$565
8	\$2,169	\$825	\$585
9	\$2,255	\$855	\$605
10	\$2,345	\$885	\$625
11	\$2,435	\$915	\$645
12	\$2,525	\$945	\$665
13	\$2,615	\$975	\$689
14	\$2,705	\$1,005	\$709
15	\$2,795	\$1,035	\$729

**8mm**

Finger Size	\$1,700 Platinum	\$1,600 14kt Gold	\$1,600 10kt Gold
4	\$2,625	\$1,005	\$709
5	\$2,755	\$1,055	\$745
6	\$2,889	\$1,099	\$775
7	\$3,019	\$1,145	\$805
8	\$3,155	\$1,189	\$835
9	\$3,285	\$1,235	\$869
10	\$3,415	\$1,285	\$899
11	\$3,549	\$1,329	\$935
12	\$3,679	\$1,375	\$965
13	\$3,815	\$1,419	\$995
14	\$3,945	\$1,465	\$1,029
15	\$4,075	\$1,515	\$1,059

# MILGRAIN BANDS



## MGL

### Milgrain Light

Flat surface against the finger, domed surface away from the finger, with narrow beaded edges, averages 72% as thick as Milgrain.

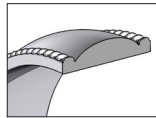

cross sectional view

#### Available Widths



3mm

4mm

5mm

6mm



## MGRL

### Comfort-Fit Milgrain Light

Rounded surface against the finger, domed surface away from the finger, with narrow beaded edges, averages 84% as thick as Milgrain Comfort Fit.

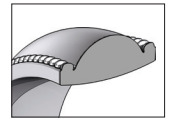

cross sectional view

#### Available Widths



4mm

5mm

6mm

### Available Finger Sizes

4 | 4.5 | 5 | 5.5 | 6 | 6.5 | 7 | 7.5 | 8 | 8.5 | 9 | 9.5 | 10 | 10.5 | 11 | 11.5 | 12 | 12.5 | 13 | 13.5 | 14 | 14.5 | 15 | 15.5

### Special Finishes



Bead Blast / Matte



Glass Blast



Ice

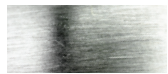

Satin / Brushed

### Available Metal Qualities



Platinum  
950



Continuum™  
Sterling Silver



White Gold  
10kt  
14kt  
18kt  
14kt X1



Sterling Silver



Yellow Gold  
10kt  
14kt  
18kt



Palladium



Rose Gold  
10kt  
14kt  
18kt

### Engraving

Engrave a message for \$30 per location. Add a color fill for \$10. Use your own handwriting or choose from:

Bookman Old Style  
*Lucida Handwriting*  
**Old English**  
*Script MT Bold*  
Colonna MT  
*Edwardian Script*

See **page 385** for engraving and special finish details.

**MGL**

**3mm**

Finger Size	\$1,700 Platinum	\$1,600 14kt Gold	\$1,600 10kt Gold
4	\$645	\$245	\$185
5	\$669	\$255	\$195
6	\$699	\$269	\$199
7	\$725	\$279	\$205
8	\$749	\$285	\$215
9	\$755	\$295	\$219
10	\$809	\$309	\$229
11	\$839	\$319	\$235
12	\$865	\$329	\$239
13	\$889	\$335	\$249
14	\$925	\$349	\$255
15	\$949	\$359	\$265

**4mm**

Finger Size	\$1,700 Platinum	\$1,600 14kt Gold	\$1,600 10kt Gold
4	\$819	\$315	\$229
5	\$865	\$329	\$239
6	\$899	\$339	\$249
7	\$935	\$355	\$259
8	\$975	\$369	\$269
9	\$1,015	\$385	\$279
10	\$1,049	\$395	\$289
11	\$1,085	\$409	\$295
12	\$1,125	\$425	\$305
13	\$1,165	\$435	\$315
14	\$1,199	\$449	\$325
15	\$1,235	\$465	\$335

**5mm**

Finger Size	\$1,700 Platinum	\$1,600 14kt Gold	\$1,600 10kt Gold
4	\$1,059	\$399	\$289
5	\$1,109	\$415	\$305
6	\$1,149	\$435	\$315
7	\$1,195	\$445	\$325
8	\$1,235	\$465	\$335
9	\$1,279	\$479	\$345
10	\$1,325	\$495	\$355
11	\$1,369	\$509	\$365
12	\$1,415	\$525	\$379
13	\$1,455	\$545	\$389
14	\$1,495	\$555	\$399
15	\$1,539	\$575	\$409

**6mm**

Finger Size	\$1,700 Platinum	\$1,600 14kt Gold	\$1,600 10kt Gold
4	\$1,275	\$475	\$345
5	\$1,335	\$499	\$359
6	\$1,385	\$515	\$375
7	\$1,439	\$539	\$385
8	\$1,499	\$559	\$405
9	\$1,559	\$579	\$415
10	\$1,565	\$605	\$429
11	\$1,675	\$625	\$445
12	\$1,735	\$645	\$459
13	\$1,795	\$665	\$475
14	\$1,855	\$685	\$489
15	\$1,909	\$709	\$505

**MGRL**

**4mm**

Finger Size	\$1,700 Platinum	\$1,600 14kt Gold	\$1,600 10kt Gold
4	\$1,385	\$515	\$375
5	\$1,425	\$535	\$389
6	\$1,515	\$555	\$405
7	\$1,555	\$579	\$419
8	\$1,575	\$599	\$435
9	\$1,649	\$625	\$449
10	\$1,705	\$645	\$459
11	\$1,779	\$665	\$475
12	\$1,915	\$685	\$489
13	\$1,899	\$705	\$505
14	\$2,025	\$729	\$519
15	\$2,085	\$749	\$535

**5mm**

Finger Size	\$1,700 Platinum	\$1,600 14kt Gold	\$1,600 10kt Gold
4	\$1,705	\$659	\$475
5	\$1,779	\$689	\$495
6	\$1,855	\$719	\$515
7	\$1,935	\$745	\$535
8	\$2,009	\$775	\$555
9	\$2,085	\$805	\$575
10	\$2,159	\$835	\$595
11	\$2,235	\$859	\$615
12	\$2,315	\$889	\$635
13	\$2,565	\$919	\$655
14	\$2,025	\$949	\$675
15	\$2,725	\$975	\$695

**6mm**

Finger Size	\$1,700 Platinum	\$1,600 14kt Gold	\$1,600 10kt Gold
4	\$2,125	\$819	\$585
5	\$2,229	\$859	\$609
6	\$2,335	\$899	\$639
7	\$2,429	\$935	\$665
8	\$2,535	\$975	\$695
9	\$2,635	\$1,015	\$719
10	\$2,739	\$1,055	\$745
11	\$2,839	\$1,089	\$775
12	\$2,935	\$1,129	\$795
13	\$3,265	\$1,165	\$825
14	\$3,369	\$1,205	\$849
15	\$3,479	\$1,245	\$875

Most items available in any metal quality.

Suggested retail prices based on \$1,600 gold, \$1,700 platinum and \$30 silver. Visit [stuller.com](http://stuller.com) for our complete product selections and current pricing. | 395

# MILGRAIN BANDS



## MGR

### Comfort-Fit Milgrain

Rounded surface against the finger, domed surface away from the finger, with narrow beaded edges.

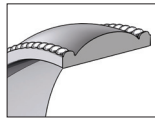

cross sectional view

#### Available Widths



3mm



4mm



5mm



6mm



## DMGR

### Comfort-Fit Double Milgrain

Rounded surface against the finger, domed surface away from the finger, with double beaded edges.

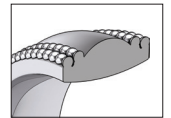

cross sectional view

#### Available Widths



4mm



6mm



8mm

### Available Finger Sizes

4 | 4.5 | 5 | 5.5 | 6 | 6.5 | 7 | 7.5 | 8 | 8.5 | 9 | 9.5 | 10 | 10.5 | 11 | 11.5 | 12 | 12.5 | 13 | 13.5 | 14 | 14.5 | 15 | 15.5

### Special Finishes



Bead Blast / Matte



Glass Blast



Ice

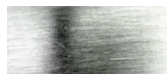

Satin / Brushed

### Available Metal Qualities



**Platinum  
950**



**Continuum™  
Sterling Silver**



**White Gold**  
10kt  
14kt  
18kt  
14kt X1



**Sterling Silver**



**Yellow Gold**  
10kt  
14kt  
18kt



**Palladium**



**Rose Gold**  
10kt  
14kt  
18kt

### Engraving

Engrave a message for \$30 per location. Add a color fill for \$10. Use your own handwriting or choose from:

Bookman Old Style  
*Lucida Handwriting*  
**Old English**  
*Script MT Bold*  
Colonna MT  
*Edwardian Script*

See **page 385** for engraving and special finish details.

**MGR**

**3mm**

Finger Size	\$1,700 Platinum	\$1,600 14kt Gold	\$1,600 10kt Gold
4	\$1,355	\$489	\$355
5	\$1,409	\$509	\$369
6	\$1,495	\$529	\$385
7	\$1,495	\$549	\$395
8	\$1,554	\$569	\$409
9	\$1,615	\$589	\$425
10	\$1,666	\$609	\$439
11	\$1,725	\$629	\$455
12	\$1,782	\$649	\$465
13	\$1,839	\$669	\$479
14	\$1,895	\$689	\$495
15	\$1,952	\$709	\$509

**4mm**

Finger Size	\$1,700 Platinum	\$1,600 14kt Gold	\$1,600 10kt Gold
4	\$1,759	\$645	\$465
5	\$1,799	\$675	\$485
6	\$1,875	\$699	\$499
7	\$1,949	\$725	\$519
8	\$2,025	\$749	\$535
9	\$2,099	\$775	\$555
10	\$2,175	\$805	\$575
11	\$2,249	\$829	\$589
12	\$2,325	\$855	\$609
13	\$2,435	\$879	\$625
14	\$2,429	\$905	\$645
15	\$2,745	\$935	\$665

**5mm**

Finger Size	\$1,700 Platinum	\$1,600 14kt Gold	\$1,600 10kt Gold
4	\$2,045	\$779	\$555
5	\$2,195	\$815	\$579
6	\$2,305	\$849	\$605
7	\$2,409	\$885	\$629
8	\$2,519	\$915	\$655
9	\$2,625	\$955	\$675
10	\$2,735	\$985	\$699
11	\$2,845	\$1,025	\$725
12	\$2,949	\$1,055	\$749
13	\$3,109	\$1,089	\$775
14	\$3,319	\$1,125	\$795
15	\$3,559	\$1,159	\$819

**6mm**

Finger Size	\$1,700 Platinum	\$1,600 14kt Gold	\$1,600 10kt Gold
4	\$2,465	\$925	\$659
5	\$2,635	\$965	\$689
6	\$2,505	\$1,009	\$715
7	\$2,895	\$1,055	\$745
8	\$3,019	\$1,095	\$775
9	\$3,145	\$1,135	\$805
10	\$3,275	\$1,179	\$835
11	\$3,399	\$1,225	\$865
12	\$3,525	\$1,265	\$895
13	\$3,719	\$1,305	\$919
14	\$3,975	\$1,349	\$949
15	\$4,255	\$1,395	\$979

**DMGR**

**4mm**

Finger Size	\$1,700 Platinum	\$1,600 14kt Gold	\$1,600 10kt Gold
4	\$1,825	\$655	\$489
5	\$1,895	\$689	\$509
6	\$1,965	\$719	\$525
7	\$2,035	\$749	\$545
8	\$2,105	\$785	\$559
9	\$2,175	\$815	\$575
10	\$2,245	\$849	\$595
11	\$2,309	\$885	\$609
12	\$2,379	\$915	\$629
13	\$2,445	\$949	\$645
14	\$2,515	\$979	\$665
15	\$2,585	\$1,015	\$679

**6mm**

Finger Size	\$1,700 Platinum	\$1,600 14kt Gold	\$1,600 10kt Gold
4	\$2,505	\$919	\$659
5	\$2,599	\$959	\$685
6	\$2,705	\$999	\$709
7	\$2,799	\$1,039	\$735
8	\$2,895	\$1,079	\$755
9	\$2,995	\$1,119	\$785
10	\$3,089	\$1,159	\$805
11	\$3,185	\$1,199	\$829
12	\$3,285	\$1,239	\$775
13	\$3,385	\$1,279	\$879
14	\$3,475	\$1,319	\$905
15	\$3,579	\$1,355	\$925

**8mm**

Finger Size	\$1,700 Platinum	\$1,600 14kt Gold	\$1,600 10kt Gold
4	\$3,475	\$1,295	\$905
5	\$3,625	\$1,355	\$939
6	\$3,765	\$1,405	\$975
7	\$3,905	\$1,459	\$1,009
8	\$4,049	\$1,515	\$1,045
9	\$4,195	\$1,565	\$1,085
10	\$4,339	\$1,619	\$1,119
11	\$4,485	\$1,675	\$1,155
12	\$4,629	\$1,725	\$1,189
13	\$4,775	\$1,779	\$1,225
14	\$4,915	\$1,835	\$1,259
15	\$5,059	\$1,889	\$1,295

Most items available in any metal quality.

Suggested retail prices based on \$1,600 gold, \$1,700 platinum and \$30 silver. Visit [stuller.com](http://stuller.com) for our complete product selections and current pricing. | 397



IR

### Inside Round

Also called Comfort Fit; rounded surface against the finger, domed surface away from the finger.

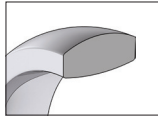

cross sectional view



### Available Widths



### Available Finger Sizes

4 | 4.5 | 5 | 5.5 | 6 | 6.5 | 7 | 7.5 | 8 | 8.5 | 9 | 9.5 | 10 | 10.5 | 11 | 11.5 | 12 | 12.5 | 13 | 13.5 | 14 | 14.5 | 15 | 15.5

### Special Finishes



Bead Blast / Matte



Ice



Florentine

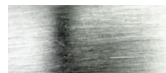

Satin / Brushed



Glass Blast



Stone



Hammered

### Available Metal Qualities



Platinum  
950



Continuum™  
Sterling Silver



White Gold  
10kt  
14kt  
18kt  
14kt X1



Sterling Silver



Yellow Gold  
10kt  
14kt  
18kt



Palladium



Rose Gold  
10kt  
14kt  
18kt

### Engraving

Engrave a message for \$30 per location. Add a color fill for \$10. Use your own handwriting or choose from:

Bookman Old Style  
Lucida Handwriting  
Old English  
Script *MT Bold*  
Colonna MT  
Edwardian Script

See **page 385** for engraving and special finish details.

## 2mm

Finger Size	\$1,700 Platinum	\$1,600 14kt Gold	\$1,600 10kt Gold
4	\$815	\$289	\$209
5	\$845	\$305	\$219
6	\$875	\$319	\$229
7	\$909	\$329	\$235
8	\$939	\$335	\$245
9	\$969	\$349	\$255
10	\$1,005	\$359	\$265
11	\$1,035	\$369	\$269
12	\$1,059	\$379	\$275
13	\$1,095	\$395	\$285
14	\$1,125	\$405	\$295
15	\$1,155	\$419	\$299

## 3mm

Finger Size	\$1,700 Platinum	\$1,600 14kt Gold	\$1,600 10kt Gold
4	\$1,429	\$525	\$375
5	\$1,495	\$545	\$389
6	\$1,565	\$569	\$405
7	\$1,635	\$589	\$419
8	\$1,705	\$615	\$435
9	\$1,769	\$635	\$449
10	\$1,839	\$659	\$465
11	\$1,909	\$685	\$485
12	\$1,975	\$705	\$499
13	\$2,045	\$729	\$515
14	\$2,115	\$749	\$529
15	\$2,185	\$775	\$545

## 4mm

Finger Size	\$1,700 Platinum	\$1,600 14kt Gold	\$1,600 10kt Gold
4	\$1,795	\$669	\$475
5	\$1,879	\$705	\$495
6	\$1,969	\$735	\$515
7	\$2,055	\$765	\$539
8	\$2,145	\$795	\$559
9	\$2,235	\$825	\$579
10	\$2,319	\$855	\$605
11	\$2,409	\$885	\$625
12	\$2,495	\$915	\$645
13	\$2,585	\$949	\$665
14	\$2,669	\$979	\$689
15	\$2,759	\$1,009	\$709

## 5mm

Finger Size	\$1,700 Platinum	\$1,600 14kt Gold	\$1,600 10kt Gold
4	\$2,219	\$825	\$585
5	\$2,325	\$865	\$605
6	\$2,429	\$899	\$635
7	\$2,529	\$935	\$655
8	\$2,635	\$969	\$685
9	\$2,739	\$1,005	\$705
10	\$2,845	\$1,039	\$729
11	\$2,955	\$1,075	\$755
12	\$3,059	\$1,115	\$779
13	\$3,155	\$1,149	\$805
14	\$3,259	\$1,185	\$829
15	\$3,365	\$1,219	\$865

## 6mm

Finger Size	\$1,700 Platinum	\$1,600 14kt Gold	\$1,600 10kt Gold
4	\$2,615	\$975	\$685
5	\$2,745	\$1,015	\$715
6	\$2,875	\$1,059	\$745
7	\$2,999	\$1,125	\$775
8	\$3,129	\$1,149	\$805
9	\$3,259	\$1,195	\$835
10	\$3,385	\$1,239	\$865
11	\$3,515	\$1,285	\$895
12	\$3,645	\$1,325	\$925
13	\$3,769	\$1,369	\$955
14	\$3,899	\$1,415	\$989
15	\$4,025	\$1,459	\$1,019

## 7mm

Finger Size	\$1,700 Platinum	\$1,600 14kt Gold	\$1,600 10kt Gold
4	\$3,035	\$1,119	\$785
5	\$3,189	\$1,169	\$819
6	\$3,455	\$1,219	\$855
7	\$3,495	\$1,275	\$889
8	\$3,649	\$1,325	\$925
9	\$3,805	\$1,375	\$959
10	\$3,959	\$1,425	\$995
11	\$4,115	\$1,475	\$1,029
12	\$4,265	\$1,525	\$1,065
13	\$4,419	\$1,575	\$1,095
14	\$4,575	\$1,625	\$1,135
15	\$4,725	\$1,675	\$1,165

## 8mm

Finger Size	\$1,700 Platinum	\$1,600 14kt Gold	\$1,600 10kt Gold
4	\$3,459	\$1,279	\$895
5	\$3,635	\$1,335	\$935
6	\$3,815	\$1,395	\$975
7	\$3,989	\$1,455	\$1,015
8	\$4,169	\$1,515	\$1,055
9	\$4,345	\$1,569	\$1,095
10	\$4,525	\$1,629	\$1,135
11	\$4,699	\$1,685	\$1,175
12	\$4,875	\$1,745	\$1,215
13	\$5,055	\$1,805	\$1,255
14	\$5,229	\$1,865	\$1,295
15	\$5,409	\$1,919	\$1,339

**IRL**

**Inside Round Light**

Also called Comfort Fit Light, rounded against the finger, domed away from the finger, thickness approximately 70% of Inside Round.

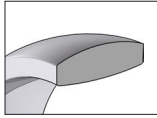

cross sectional view

**Available Widths**



**Available Finger Sizes**

4 | 4.5 | 5 | 5.5 | 6 | 6.5 | 7 | 7.5 | 8 | 8.5 | 9 | 9.5 | 10 | 10.5 | 11 | 11.5 | 12 | 12.5 | 13 | 13.5 | 14 | 14.5 | 15 | 15.5

**Special Finishes**



Bead Blast / Matte



Ice



Florentine

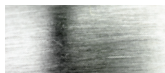

Satin / Brushed



Glass Blast



Stone



Hammered

**Available Metal Qualities**



**Platinum**  
950



**Continuum™**  
Sterling Silver



**White Gold**  
10kt  
14kt  
18kt  
14kt X1



**Sterling Silver**



**Yellow Gold**  
10kt  
14kt  
18kt



**Palladium**



**Rose Gold**  
10kt  
14kt  
18kt

**Engraving**

Engrave a message for \$30 per location. Add a color fill for \$10. Use your own handwriting or choose from:

Bookman Old Style  
Lucida Handwriting  
Old English  
Script MT Bold  
Colonna MT  
Edwardian Script

See **page 385** for engraving and special finish details.

2mm

Finger Size	\$1,700 Platinum	\$1,600 14kt Gold	\$1,600 10kt Gold
4	\$635	\$219	\$165
5	\$659	\$229	\$169
6	\$685	\$269	\$175
7	\$709	\$249	\$185
8	\$735	\$259	\$189
9	\$759	\$269	\$195
10	\$785	\$279	\$205
11	\$815	\$289	\$209
12	\$835	\$299	\$215
13	\$865	\$309	\$225
14	\$885	\$319	\$229
15	\$915	\$325	\$235

3mm

Finger Size	\$1,700 Platinum	\$1,600 14kt Gold	\$1,600 10kt Gold
4	\$915	\$335	\$245
5	\$955	\$349	\$255
6	\$999	\$365	\$265
7	\$1,045	\$379	\$275
8	\$1,045	\$395	\$285
9	\$1,129	\$405	\$295
10	\$1,169	\$419	\$305
11	\$1,215	\$435	\$315
12	\$1,255	\$449	\$325
13	\$1,319	\$465	\$335
14	\$2,145	\$479	\$345
15	\$2,299	\$495	\$355

4mm

Finger Size	\$1,700 Platinum	\$1,600 14kt Gold	\$1,600 10kt Gold
4	\$1,255	\$455	\$325
5	\$1,315	\$479	\$345
6	\$1,375	\$499	\$355
7	\$1,435	\$519	\$375
8	\$1,495	\$545	\$385
9	\$1,555	\$565	\$399
10	\$1,615	\$585	\$415
11	\$1,675	\$605	\$429
12	\$1,735	\$625	\$445
13	\$1,799	\$649	\$459
14	\$1,945	\$669	\$475
15	\$2,089	\$689	\$489

5mm

Finger Size	\$1,700 Platinum	\$1,600 14kt Gold	\$1,600 10kt Gold
4	\$1,565	\$569	\$405
5	\$1,645	\$595	\$419
6	\$1,719	\$619	\$439
7	\$1,795	\$645	\$459
8	\$1,869	\$675	\$475
9	\$1,949	\$699	\$495
10	\$2,035	\$725	\$515
11	\$2,099	\$755	\$535
12	\$2,179	\$779	\$549
13	\$2,295	\$805	\$569
14	\$2,455	\$835	\$585
15	\$2,635	\$859	\$605

6mm

Finger Size	\$1,700 Platinum	\$1,600 14kt Gold	\$1,600 10kt Gold
4	\$1,929	\$715	\$505
5	\$2,029	\$745	\$525
6	\$2,125	\$775	\$545
7	\$2,225	\$809	\$569
8	\$2,325	\$839	\$589
9	\$2,419	\$869	\$615
10	\$2,519	\$905	\$635
11	\$2,615	\$935	\$655
12	\$2,709	\$965	\$679
13	\$2,655	\$999	\$699
14	\$4,715	\$1,029	\$725
15	\$2,765	\$1,059	\$745

7mm

Finger Size	\$1,700 Platinum	\$1,600 14kt Gold	\$1,600 10kt Gold
4	\$2,215	\$815	\$575
5	\$2,325	\$849	\$599
6	\$2,435	\$885	\$625
7	\$2,539	\$925	\$649
8	\$2,649	\$959	\$675
9	\$2,759	\$995	\$699
10	\$2,865	\$1,035	\$725
11	\$2,975	\$1,069	\$749
12	\$3,085	\$1,105	\$775
13	\$2,945	\$1,145	\$799
14	\$5,359	\$1,179	\$825
15	\$3,149	\$1,215	\$849

8mm

Finger Size	\$1,700 Platinum	\$1,600 14kt Gold	\$1,600 10kt Gold
4	\$2,579	\$945	\$665
5	\$2,705	\$985	\$695
6	\$2,829	\$1,029	\$725
7	\$2,955	\$1,075	\$755
8	\$3,085	\$1,115	\$785
9	\$3,209	\$1,159	\$815
10	\$3,335	\$1,205	\$845
11	\$3,455	\$1,245	\$875
12	\$3,585	\$1,289	\$905
13	\$3,465	\$1,335	\$935
14	\$3,585	\$1,375	\$965
15	\$6,689	\$1,419	\$995

## COMFORT-FIT BANDS

**IRH**

### Inside Round Heavy

Also called Heavy Comfort-Fit, rounded surface against the finger, domed surface away from the finger, thickness approximately 15% greater than IR.

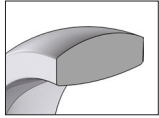

cross sectional view



### Available Widths



3mm



4mm



6mm

### Available Finger Sizes

4 | 4.5 | 5 | 5.5 | 6 | 6.5 | 7 | 7.5 | 8 | 8.5 | 9 | 9.5 | 10 | 10.5 | 11 | 11.5 | 12 | 12.5 | 13 | 13.5 | 14 | 14.5 | 15 | 15.5

### Special Finishes



Bead Blast / Matte

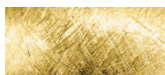

Ice



Florentine

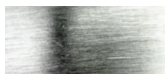

Satin / Brushed



Glass Blast



Stone



Hammered

### Available Metal Qualities



**Platinum  
950**



**Continuum™  
Sterling Silver**



**White Gold**  
10kt  
14kt  
18kt  
14kt X1



**Sterling Silver**



**Yellow Gold**  
10kt  
14kt  
18kt



**Palladium**



**Rose Gold**  
10kt  
14kt  
18kt

### Engraving

Engrave a message for \$30 per location. Add a color fill for \$10. Use your own handwriting or choose from:

Bookman Old Style  
Lucida Handwriting  
**Old English**  
**Script MT Bold**  
Colonna MT  
*Edwardian Script*

See **page 385** for engraving and special finish details.

**3mm**

Finger Size	\$1,700 Platinum	\$1,600 14kt Gold	\$1,600 10kt Gold
4	\$1,675	\$589	\$435
5	\$1,755	\$619	\$435
6	\$1,815	\$645	\$455
7	\$1,875	\$675	\$475
8	\$1,975	\$705	\$495
9	\$2,055	\$735	\$515
10	\$2,109	\$765	\$535
11	\$2,215	\$789	\$555
12	\$2,665	\$819	\$575
13	\$2,309	\$845	\$595
14	\$2,389	\$875	\$615
15	\$2,469	\$905	\$635

**4mm**

Finger Size	\$1,700 Platinum	\$1,600 14kt Gold	\$1,600 10kt Gold
4	\$2,205	\$765	\$535
5	\$2,339	\$795	\$575
6	\$2,385	\$835	\$585
7	\$2,539	\$875	\$609
8	\$2,629	\$909	\$635
9	\$2,715	\$945	\$659
10	\$2,805	\$985	\$685
11	\$2,919	\$1,019	\$715
12	\$3,005	\$1,055	\$735
13	\$2,979	\$1,089	\$759
14	\$3,079	\$1,125	\$785
15	\$3,179	\$1,165	\$809

**6mm**

Finger Size	\$1,700 Platinum	\$1,600 14kt Gold	\$1,600 10kt Gold
4	\$3,215	\$1,179	\$819
5	\$3,485	\$1,209	\$845
6	\$3,559	\$1,285	\$935
7	\$3,715	\$1,375	\$975
8	\$3,885	\$1,445	\$975
9	\$3,989	\$1,479	\$915
10	\$4,165	\$1,499	\$1,089
11	\$4,345	\$1,545	\$1,069
12	\$4,449	\$1,625	\$1,125
13	\$4,569	\$1,669	\$1,145
14	\$4,729	\$1,725	\$1,195
15	\$4,885	\$1,785	\$1,259

# FLAT BANDS

## FIR

### Flat Comfort-Fit

Rounded surface against the finger, flat surface away from the finger.

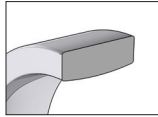

cross sectional view

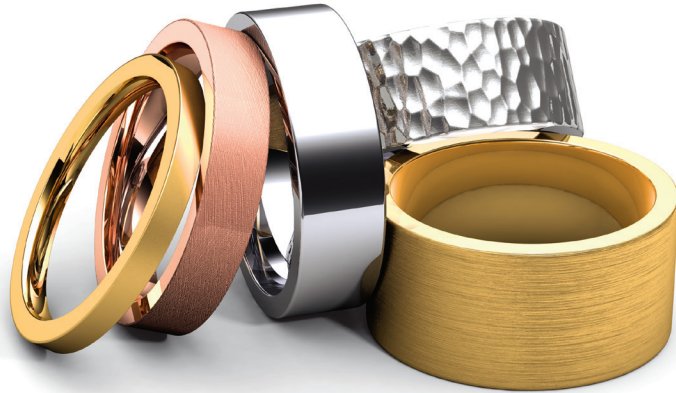

### Available Widths



2mm



2.5mm



3mm



4mm



5mm



6mm



7mm



8mm



10mm



12mm

### Available Finger Sizes

4 | 4.5 | 5 | 5.5 | 6 | 6.5 | 7 | 7.5 | 8 | 8.5 | 9 | 9.5 | 10 | 10.5 | 11 | 11.5 | 12 | 12.5 | 13 | 13.5 | 14 | 14.5 | 15 | 15.5

### Special Finishes



Bead Blast / Matte



Ice



Florentine

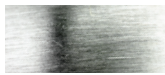

Satin / Brushed



Glass Blast



Stone



Hammered

### Available Metal Qualities



**Platinum**  
950



**Continuum™**  
Sterling Silver



**White Gold**  
10kt  
14kt  
18kt  
14kt X1



**Sterling Silver**



**Yellow Gold**  
10kt  
14kt  
18kt



**Palladium**



**Rose Gold**  
10kt  
14kt  
18kt

### Engraving

Engrave a message for \$30 per location. Add a color fill for \$10. Use your own handwriting or choose from:

- Bookman Old Style
- Lucida Handwriting
- Old English
- Script MT Bold
- Colonna MT
- Edwardian Script

See **page 385** for engraving and special finish details.

**FIR**

**2mm**

Finger Size	\$1,700 Platinum	\$1,600 14kt Gold	\$1,600 10kt Gold
4	\$955	\$339	\$245
5	\$989	\$355	\$255
6	\$1,025	\$365	\$259
7	\$1,059	\$379	\$269
8	\$1,095	\$395	\$279
9	\$1,129	\$405	\$289
10	\$1,165	\$419	\$295
11	\$1,195	\$435	\$305
12	\$1,235	\$445	\$315
13	\$1,235	\$455	\$325
14	\$1,275	\$469	\$329
15	\$1,309	\$485	\$345

**2.5mm**

Finger Size	\$1,700 Platinum	\$1,600 14kt Gold	\$1,600 10kt Gold
4	\$1,099	\$405	\$289
5	\$1,139	\$425	\$299
6	\$1,189	\$439	\$315
7	\$1,295	\$455	\$325
8	\$1,349	\$475	\$335
9	\$1,405	\$489	\$345
10	\$1,459	\$505	\$355
11	\$1,509	\$525	\$369
12	\$1,565	\$539	\$379
13	\$1,619	\$555	\$389
14	\$1,675	\$575	\$399
15	\$1,725	\$589	\$415

**3mm**

Finger Size	\$1,700 Platinum	\$1,600 14kt Gold	\$1,600 10kt Gold
4	\$1,355	\$475	\$335
5	\$1,409	\$495	\$349
6	\$1,459	\$515	\$365
7	\$1,515	\$535	\$375
8	\$1,565	\$555	\$389
9	\$1,619	\$575	\$405
10	\$1,675	\$595	\$415
11	\$1,725	\$615	\$429
12	\$1,775	\$635	\$445
13	\$1,789	\$655	\$459
14	\$1,839	\$675	\$475
15	\$1,899	\$699	\$485

**4mm**

Finger Size	\$1,700 Platinum	\$1,600 14kt Gold	\$1,600 10kt Gold
4	\$1,739	\$635	\$445
5	\$1,819	\$649	\$455
6	\$1,895	\$665	\$515
7	\$1,969	\$685	\$479
8	\$2,049	\$705	\$489
9	\$2,125	\$719	\$505
10	\$2,205	\$739	\$515
11	\$2,285	\$759	\$525
12	\$2,359	\$775	\$539
13	\$2,165	\$795	\$555
14	\$2,405	\$815	\$565
15	\$2,265	\$829	\$575

**5mm**

Finger Size	\$1,700 Platinum	\$1,600 14kt Gold	\$1,600 10kt Gold
4	\$2,205	\$779	\$545
5	\$2,285	\$805	\$555
6	\$2,369	\$825	\$575
7	\$2,449	\$849	\$589
8	\$2,529	\$955	\$605
9	\$2,609	\$899	\$625
10	\$2,689	\$925	\$639
11	\$2,769	\$945	\$655
12	\$2,849	\$969	\$675
13	\$2,715	\$995	\$689
14	\$2,785	\$1,019	\$705
15	\$2,845	\$1,039	\$719

**6mm**

Finger Size	\$1,700 Platinum	\$1,600 14kt Gold	\$1,600 10kt Gold
4	\$2,685	\$909	\$629
5	\$2,775	\$949	\$659
6	\$2,869	\$985	\$685
7	\$2,959	\$1,025	\$709
8	\$3,055	\$1,065	\$735
9	\$3,139	\$1,105	\$765
10	\$3,235	\$1,145	\$789
11	\$3,325	\$1,179	\$815
12	\$3,415	\$1,219	\$845
13	\$3,439	\$1,259	\$865
14	\$2,795	\$1,295	\$895
15	\$3,655	\$1,335	\$919

**7mm**

Finger Size	\$1,700 Platinum	\$1,600 14kt Gold	\$1,600 10kt Gold
4	\$3,329	\$1,075	\$745
5	\$3,495	\$1,125	\$775
6	\$3,655	\$1,169	\$805
7	\$3,819	\$1,215	\$839
8	\$3,979	\$1,265	\$875
9	\$4,125	\$1,309	\$905
10	\$4,285	\$1,359	\$935
11	\$4,449	\$1,405	\$969
12	\$4,609	\$1,455	\$999
13	\$4,155	\$1,499	\$1,035
14	\$4,235	\$1,545	\$1,065
15	\$4,365	\$1,595	\$1,095

**8mm**

Finger Size	\$1,700 Platinum	\$1,600 14kt Gold	\$1,600 10kt Gold
4	\$3,489	\$1,229	\$849
5	\$3,665	\$1,275	\$879
6	\$3,835	\$1,315	\$909
7	\$3,999	\$1,359	\$939
8	\$4,175	\$1,405	\$969
9	\$4,319	\$1,449	\$999
10	\$4,419	\$1,489	\$1,025
11	\$4,659	\$1,535	\$1,059
12	\$4,825	\$1,579	\$1,089
13	\$4,869	\$1,625	\$1,115
14	\$4,565	\$1,665	\$1,145
15	\$4,685	\$1,709	\$1,175

**10mm**

Finger Size	\$1,700 Platinum	\$1,600 14kt Gold	\$1,600 10kt Gold
4	\$4,359	\$1,475	\$1,015
5	\$4,575	\$1,545	\$1,065
6	\$4,785	\$1,615	\$1,109
7	\$5,005	\$1,685	\$1,159
8	\$5,109	\$1,755	\$1,205
9	\$5,395	\$1,825	\$1,255
10	\$5,605	\$1,895	\$1,305
11	\$5,819	\$1,965	\$1,349
12	\$6,029	\$2,035	\$1,399
13	\$5,775	\$2,105	\$1,445
14	\$6,029	\$2,175	\$1,495
15	\$6,155	\$2,245	\$1,539

**12mm**

Finger Size	\$1,700 Platinum	\$1,600 14kt Gold	\$1,600 10kt Gold
4	\$5,235	\$1,869	\$1,285
5	\$5,489	\$1,929	\$1,325
6	\$5,749	\$1,985	\$1,365
7	\$6,009	\$2,045	\$1,405

Finger Size	\$1,700 Platinum	\$1,600 14kt Gold	\$1,600 10kt Gold
8	\$6,265	\$2,105	\$1,445
9	\$6,485	\$2,165	\$1,485
10	\$6,739	\$2,219	\$1,525
11	\$6,995	\$2,279	\$1,565

Finger Size	\$1,700 Platinum	\$1,600 14kt Gold	\$1,600 10kt Gold
12	\$7,249	\$2,335	\$1,605
13	\$6,575	\$2,395	\$1,645
14	\$7,429	\$2,455	\$1,685
15	\$6,889	\$2,515	\$1,719

Most items available in any metal quality.

Suggested retail prices based on \$1,600 gold, \$1,700 platinum and \$30 silver. Visit [stuller.com](http://stuller.com) for our complete product selections and current pricing. | 405



# FLAT BANDS

F

## Flat

Flat against the finger, flat away from the finger.

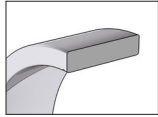

cross sectional view



### Available Widths



2mm



2.5mm



3mm



4mm



5mm



6mm



7mm



8mm



10mm



12mm

### Available Finger Sizes

4 | 4.5 | 5 | 5.5 | 6 | 6.5 | 7 | 7.5 | 8 | 8.5 | 9 | 9.5 | 10 | 10.5 | 11 | 11.5 | 12 | 12.5 | 13 | 13.5 | 14 | 14.5 | 15 | 15.5

### Special Finishes



Bead Blast / Matte



Ice



Florentine

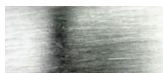

Satin / Brushed



Glass Blast



Stone



Hammered

### Available Metal Qualities



**Platinum 950**



**Continuum™ Sterling Silver**



**White Gold**  
10kt  
14kt  
18kt  
14kt X1



**Sterling Silver**



**Palladium**



**Yellow Gold**  
10kt  
14kt  
18kt



**Rose Gold**  
10kt  
14kt  
18kt

### Engraving

Engrave a message for \$30 per location. Add a color fill for \$10. Use your own handwriting or choose from:

Bookman Old Style  
Lucida Handwriting  
**Old English**  
**Script MT Bold**  
Colonna MT  
*Edwardian Script*

See **page 385** for engraving and special finish details.

**F**

**2mm**

Finger Size	\$1,700 Platinum	\$1,600 14kt Gold	\$1,600 10kt Gold
4	\$629	\$225	\$165
5	\$655	\$235	\$169
6	\$685	\$245	\$179
7	\$715	\$255	\$185
8	\$739	\$265	\$189
9	\$765	\$275	\$199
10	\$795	\$285	\$205
11	\$819	\$295	\$209
12	\$849	\$305	\$215
13	\$875	\$309	\$225
14	\$899	\$319	\$229
15	\$929	\$329	\$235

**2.5mm**

Finger Size	\$1,700 Platinum	\$1,600 14kt Gold	\$1,600 10kt Gold
4	\$745	\$275	\$199
5	\$785	\$289	\$205
6	\$815	\$299	\$215
7	\$819	\$315	\$225
8	MTO	\$325	\$235
9	MTO	\$339	\$239
10	MTO	\$355	\$249
11	MTO	\$365	\$259
12	MTO	\$375	\$269
13	MTO	\$389	\$275
14	MTO	\$405	\$429
15	MTO	\$415	\$295

**3mm**

Finger Size	\$1,700 Platinum	\$1,600 14kt Gold	\$1,600 10kt Gold
4	\$899	\$325	\$235
5	\$939	\$345	\$245
6	\$979	\$355	\$255
7	\$1,019	\$369	\$265
8	\$1,065	\$385	\$275
9	\$1,105	\$399	\$285
10	\$1,145	\$415	\$295
11	\$1,185	\$429	\$305
12	\$1,225	\$445	\$315
13	\$1,265	\$459	\$325
14	\$1,305	\$469	\$335
15	\$1,345	\$485	\$345

**4mm**

Finger Size	\$1,700 Platinum	\$1,600 14kt Gold	\$1,600 10kt Gold
4	\$1,169	\$425	\$299
5	\$1,225	\$445	\$315
6	\$1,285	\$465	\$325
7	\$1,345	\$479	\$339
8	\$1,399	\$505	\$355
9	\$1,455	\$519	\$369
10	\$1,515	\$539	\$385
11	\$1,569	\$565	\$395
12	\$1,629	\$579	\$409
13	\$1,685	\$599	\$425
14	\$1,745	\$619	\$435
15	\$1,799	\$639	\$449

**5mm**

Finger Size	\$1,700 Platinum	\$1,600 14kt Gold	\$1,600 10kt Gold
4	\$1,439	\$519	\$369
5	\$1,515	\$545	\$385
6	\$1,585	\$575	\$405
7	\$1,659	\$595	\$419
8	\$1,729	\$625	\$435
9	\$1,805	\$645	\$455
10	\$1,875	\$675	\$475
11	\$1,945	\$695	\$489
12	\$2,019	\$725	\$509
13	\$2,095	\$745	\$525
14	\$2,165	\$775	\$545
15	\$2,239	\$795	\$559

**6mm**

Finger Size	\$1,700 Platinum	\$1,600 14kt Gold	\$1,600 10kt Gold
4	\$1,719	\$619	\$435
5	\$1,815	\$645	\$455
6	\$1,905	\$675	\$475
7	\$1,995	\$705	\$495
8	\$2,089	\$735	\$515
9	\$2,179	\$765	\$535
10	\$2,269	\$795	\$555
11	\$2,359	\$825	\$575
12	\$2,455	\$855	\$599
13	\$2,545	\$885	\$615
14	\$2,635	\$909	\$639
15	\$2,729	\$939	\$659

**7mm**

Finger Size	\$1,700 Platinum	\$1,600 14kt Gold	\$1,600 10kt Gold
4	\$1,985	\$705	\$495
5	\$2,085	\$739	\$519
6	\$2,195	\$779	\$545
7	\$2,295	\$815	\$569
8	\$2,399	\$849	\$595
9	\$2,505	\$885	\$619
10	\$2,509	\$919	\$639
11	\$2,715	\$955	\$669
12	\$2,819	\$995	\$695
13	\$2,919	\$1,025	\$719
14	\$3,029	\$1,065	\$739
15	\$3,129	\$1,099	\$765

**8mm**

Finger Size	\$1,700 Platinum	\$1,600 14kt Gold	\$1,600 10kt Gold
4	\$2,245	\$825	\$575
5	\$2,359	\$859	\$605
6	\$2,475	\$899	\$629
7	\$2,595	\$935	\$655
8	\$2,709	\$975	\$685
9	\$2,825	\$1,015	\$705
10	\$2,939	\$1,049	\$735
11	\$3,055	\$1,089	\$759
12	\$3,175	\$1,125	\$785
13	\$3,289	\$1,165	\$815
14	\$3,405	\$1,205	\$839
15	\$3,525	\$1,239	\$865

**10mm**

Finger Size	\$1,700 Platinum	\$1,600 14kt Gold	\$1,600 10kt Gold
4	\$2,785	\$1,019	\$715
5	\$2,919	\$1,075	\$745
6	\$3,055	\$1,119	\$785
7	\$3,189	\$1,169	\$815
8	\$3,325	\$1,219	\$849
9	\$3,465	\$1,265	\$885
10	\$3,595	\$1,315	\$915
11	\$3,729	\$1,365	\$949
12	\$3,865	\$1,415	\$985
13	\$3,999	\$1,465	\$1,019
14	\$4,135	\$1,515	\$1,055
15	\$4,275	\$1,559	\$1,085

**12mm**

Finger Size	\$1,700 Platinum	\$1,600 14kt Gold	\$1,600 10kt Gold
4	\$3,415	\$1,199	\$835
5	\$3,575	\$1,265	\$879
6	\$3,729	\$1,325	\$925
7	\$3,885	\$1,385	\$965

Finger Size	\$1,700 Platinum	\$1,600 14kt Gold	\$1,600 10kt Gold
8	\$4,039	\$1,449	\$1,009
9	\$4,195	\$1,515	\$1,055
10	\$4,355	\$1,575	\$1,095
11	\$4,509	\$1,635	\$1,135

Finger Size	\$1,700 Platinum	\$1,600 14kt Gold	\$1,600 10kt Gold
12	\$4,665	\$1,695	\$1,179
13	\$4,825	\$1,759	\$1,225
14	\$4,979	\$1,819	\$1,265
15	\$5,135	\$1,885	\$1,309

Most items available in any metal quality.

Suggested retail prices based on \$1,600 gold, \$1,700 platinum and \$30 silver. Visit [stuller.com](http://stuller.com) for our complete product selections and current pricing. | 407

# FLAT BANDS

FE

## Flat Edge

Flat surface against the finger, flat surface away from the finger, with narrow polished edges.

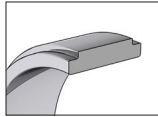

cross sectional view



### Available Widths



2.5mm



3mm



4mm



5mm



6mm



7mm



8mm



10mm

### Available Finger Sizes

4 | 4.5 | 5 | 5.5 | 6 | 6.5 | 7 | 7.5 | 8 | 8.5 | 9 | 9.5 | 10 | 10.5 | 11 | 11.5 | 12 | 12.5 | 13 | 13.5 | 14 | 14.5 | 15 | 15.5

### Special Finishes



Bead Blast / Matte



Ice



Florentine

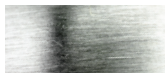

Satin / Brushed



Glass Blast



Stone

### Available Metal Qualities



**Platinum  
950**



**Continuum™  
Sterling Silver**



**White Gold  
10kt  
14kt  
18kt  
14kt X1**



**Sterling Silver**



**Yellow Gold  
10kt  
14kt  
18kt**



**Palladium**



**Rose Gold  
10kt  
14kt  
18kt**

### Engraving

Engrave a message for \$30 per location. Add a color fill for \$10. Use your own handwriting or choose from:

Bookman Old Style  
Lucida Handwriting  
**Old English**  
**Script MT Bold**  
Colonna MT  
*Edwardian Script*

See **page 385** for engraving and special finish details.

2.5mm

Finger Size	\$1,700 Platinum	\$1,600 14kt Gold	\$1,600 10kt Gold
4	\$595	\$245	\$179
5	\$665	\$255	\$189
6	\$689	\$265	\$195
7	\$725	\$275	\$205
8	\$749	\$285	\$209
9	\$785	\$295	\$215
10	\$809	\$305	\$225
11	\$835	\$315	\$235
12	\$865	\$325	\$239
13	\$885	\$335	\$245
14	\$905	\$349	\$255
15	\$949	\$359	\$259

3mm

Finger Size	\$1,700 Platinum	\$1,600 14kt Gold	\$1,600 10kt Gold
4	\$769	\$295	\$215
5	\$815	\$309	\$225
6	\$979	\$319	\$235
7	\$845	\$335	\$245
8	\$895	\$349	\$255
9	\$889	\$365	\$265
10	\$1,005	\$375	\$275
11	\$1,039	\$389	\$285
12	\$1,075	\$405	\$295
13	\$1,119	\$419	\$305
14	\$1,075	\$435	\$315
15	\$1,195	\$445	\$325

4mm

Finger Size	\$1,700 Platinum	\$1,600 14kt Gold	\$1,600 10kt Gold
4	\$1,025	\$385	\$279
5	\$1,075	\$405	289
6	\$1,075	\$419	\$305
7	\$1,165	\$435	\$315
8	\$1,165	\$455	\$325
9	\$1,219	\$469	\$335
10	\$1,299	\$485	\$349
11	\$1,305	\$505	\$359
12	\$1,395	\$519	\$375
13	\$1,439	\$535	\$385
14	\$1,525	\$555	\$395
15	\$1,535	\$569	\$405

5mm

Finger Size	\$1,700 Platinum	\$1,600 14kt Gold	\$1,600 10kt Gold
4	\$1,315	\$489	\$355
5	\$1,325	\$515	\$365
6	\$1,439	\$535	\$385
7	\$1,439	\$555	\$399
8	\$1,535	\$579	\$415
9	\$1,599	\$605	\$429
10	\$1,635	\$625	\$445
11	\$1,975	\$649	\$459
12	\$1,815	\$675	\$479
13	\$1,875	\$695	\$495
14	\$1,815	\$715	\$509
15	\$2,005	\$739	\$525

6mm

Finger Size	\$1,700 Platinum	\$1,600 14kt Gold	\$1,600 10kt Gold
4	\$1,525	\$565	\$405
5	\$1,599	\$595	\$425
6	\$1,669	\$619	\$445
7	\$1,699	\$649	\$459
8	\$1,775	\$675	\$479
9	\$1,835	\$705	\$499
10	\$1,905	\$729	\$515
11	\$2,045	\$755	\$535
12	\$2,119	\$785	\$555
13	\$2,199	\$815	\$575
14	\$2,349	\$839	\$595
15	\$2,349	\$865	\$609

8mm

Finger Size	\$1,700 Platinum	\$1,600 14kt Gold	\$1,600 10kt Gold
4	\$2,075	\$765	\$545
5	\$2,175	\$805	\$569
6	\$2,269	\$835	\$595
7	\$2,369	\$875	\$615
8	\$2,505	\$909	\$639
9	\$2,545	\$945	\$665
10	\$2,689	\$979	\$689
11	\$2,765	\$1,015	\$715
12	\$2,865	\$1,055	\$739
13	\$2,959	\$1,089	\$765
14	\$3,059	\$1,125	\$789
15	\$3,155	\$1,159	\$815

10mm

Finger Size	\$1,700 Platinum	\$1,600 14kt Gold	\$1,600 10kt Gold
4	\$2,645	\$975	\$685
5	\$2,915	\$1,019	\$719
6	\$2,895	\$1,065	\$749
7	\$3,015	\$1,109	\$779
8	\$3,155	\$1,155	\$809
9	\$3,259	\$1,199	\$839
10	\$3,385	\$1,245	\$875
11	\$3,269	\$1,289	\$905
12	\$3,635	\$1,335	\$935
13	\$3,755	\$1,375	\$965
14	\$3,739	\$1,419	\$995
15	\$4,005	\$1,469	\$1,025

# FLAT BANDS



**FT**

## Flat Tapered

Flat surface against the finger, flat surface away from the finger, tapering to approximately half the width of the top.

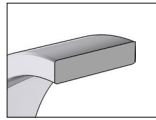

cross sectional view

### Available Widths



**SQR**

## Square Comfort-Fit

Rounded surface against the finger, soft square exterior shape.

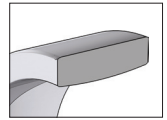

cross sectional view

### Available Widths



### Available Finger Sizes

4 | 4.5 | 5 | 5.5 | 6 | 6.5 | 7 | 7.5 | 8 | 8.5 | 9 | 9.5 | 10 | 10.5 | 11 | 11.5 | 12 | 12.5 | 13 | 13.5 | 14 | 14.5 | 15 | 15.5

### Special Finishes



Bead Blast / Matte



Ice



Florentine

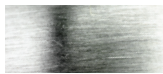

Satin / Brushed



Glass Blast



Stone



Hammered

### Available Metal Qualities



**Platinum**  
950



**Continuum™**  
Sterling Silver



**White Gold**  
10kt  
14kt  
18kt  
14kt X1



**Sterling Silver**



**Yellow Gold**  
10kt  
14kt  
18kt



**Palladium**



**Rose Gold**  
10kt  
14kt  
18kt

### Engraving

Engrave a message for \$30 per location. Add a color fill for \$10. Use your own handwriting or choose from:

Bookman Old Style  
*Lucida Handwriting*  
**Old English**  
*Script MT Bold*  
Colonna MT  
*Edwardian Script*

See **page 385** for engraving and special finish details.

**FT**

**2.5mm tapers to 1.75mm**

Finger Size	\$1,700 Platinum	\$1,900 14kt Gold	\$1,900 10kt Gold
6	\$719	\$259	\$195
10	\$825	\$309	\$225

**3mm tapers to 2mm**

Finger Size	\$1,700 Platinum	\$1,600 14kt Gold	\$1,600 10kt Gold
6	\$849	\$315	\$225
10	\$985	\$365	\$265

**4mm tapers to 2mm**

Finger Size	\$1,700 Platinum	\$1,600 14kt Gold	\$1,600 10kt Gold
6	\$949	\$365	\$265
10	\$1,115	\$415	\$295

**5mm tapers to 3mm**

Finger Size	\$1,700 Platinum	\$1,600 14kt Gold	\$1,600 10kt Gold
6	\$1,275	\$475	\$335
10	\$1,565	\$545	\$389

**6mm tapers to 3mm**

Finger Size	\$1,700 Platinum	\$1,600 14kt Gold	\$1,600 10kt Gold
6	\$1,519	\$519	\$369
10	\$1,665	\$615	\$435

**8mm tapers to 4mm**

Finger Size	\$1,700 Platinum	\$1,600 14kt Gold	\$1,600 10kt Gold
6	\$1,809	\$665	\$475
10	\$2,155	\$795	\$559

**SQR**

**2.5mm**

Finger Size	\$1,700 Platinum	\$1,600 14kt Gold	\$1,600 10kt Gold
5	\$1,039	\$379	\$289
6	\$1,125	\$395	\$299
7	\$1,155	\$419	\$325
8	\$1,259	\$445	\$345
9	\$1,205	\$475	\$329
10	\$1,255	\$469	\$339
11	\$1,295	\$485	\$349
12	\$1,339	\$499	\$359
13	\$1,385	\$515	\$375
14	\$1,519	\$535	\$409
15	\$1,465	\$545	\$395

**4mm**

Finger Size	\$1,700 Platinum	\$1,600 14kt Gold	\$1,600 10kt Gold
5	\$1,565	\$579	\$429
6	\$1,659	\$615	\$439
7	\$1,709	\$635	\$455
8	\$1,765	\$655	\$485
9	\$2,365	\$665	\$475
10	\$1,935	\$699	\$495
11	\$1,979	\$729	\$549
12	\$2,009	\$745	\$549
13	\$2,105	\$779	\$555
14	\$2,175	\$805	\$569
15	\$2,239	\$825	\$585

**6mm**

Finger Size	\$1,700 Platinum	\$1,600 14kt Gold	\$1,600 10kt Gold
5	\$2,275	\$829	\$595
6	\$2,375	\$889	\$619
7	\$2,435	\$909	\$645
8	\$2,615	\$955	\$669
9	\$2,665	\$1,025	\$695
10	\$2,765	\$1,035	\$765
11	\$3,019	\$1,059	\$769
12	\$2,909	\$1,105	\$775
13	\$3,089	\$1,139	\$799
14	\$3,195	\$1,175	\$825
15	\$3,295	\$1,209	\$849

Most items available in any metal quality.

Suggested retail prices based on \$1,600 gold, \$1,700 platinum and \$30 silver. Visit [stuller.com](http://stuller.com) for our complete product selections and current pricing. | 411

## COMFORT-FIT BANDS



**KER**

### Knife-Edge

Rounded surface against the finger, 2-sided peaked surface away from the finger.

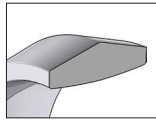

cross sectional view

#### Available Widths



2.5mm



6mm



**120421**

### Octagon Comfort-Fit

Flat against the finger, eight equal sides away from the finger.

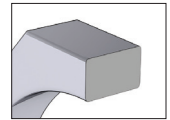

cross sectional view

#### Available Widths



4mm

### Available Finger Sizes

4 | 4.5 | 5 | 5.5 | 6 | 6.5 | 7 | 7.5 | 8 | 8.5 | 9 | 9.5 | 10 | 10.5 | 11 | 11.5 | 12 | 12.5 | 13 | 13.5 | 14 | 14.5 | 15 | 15.5

#### Special Finishes



Bead Blast / Matte



Ice



Florentine

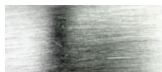

Satin / Brushed



Glass Blast



Stone

#### Available Metal Qualities



**Platinum**  
950



**Continuum™**  
Sterling Silver



**White Gold**  
10kt  
14kt  
18kt  
14kt X1



**Sterling Silver**



**Yellow Gold**  
10kt  
14kt  
18kt



**Palladium**



**Rose Gold**  
10kt  
14kt  
18kt

#### Engraving

Engrave a message for \$30 per location. Add a color fill for \$10. Use your own handwriting or choose from:

Bookman Old Style  
*Lucida Handwriting*  
**Old English**  
*Script MT Bold*  
Colonna MT  
*Edwardian Script*

See **page 385** for engraving and special finish details.

**KER****2.5mm**

Finger Size	\$1,700 Platinum	\$1,600 14kt Gold	\$1,600 10kt Gold
5	\$1,039	\$405	\$255
6	\$1,219	\$435	\$265
7	\$1,135	\$445	\$275
8	\$1,165	\$389	\$335
9	\$1,145	\$485	\$295
10	\$1,145	\$429	\$309
11	\$1,135	\$425	\$305
12	\$1,199	\$449	\$325
13	\$1,255	\$469	\$335
14	\$1,289	\$485	\$345
15	\$1,335	\$495	\$355

**6mm**

Finger Size	\$1,700 Platinum	\$1,600 14kt Gold	\$1,600 10kt Gold
5	\$2,285	\$845	\$595
6	\$2,405	\$885	\$625
7	\$2,499	\$925	\$649
8	\$2,715	\$949	\$679
9	\$2,809	\$985	\$695
10	\$2,729	\$1,045	\$729
11	\$2,969	\$1,069	\$769
12	\$3,009	\$1,105	\$799
13	\$3,089	\$1,045	\$829
14	\$3,195	\$1,175	\$825
15	\$3,305	\$1,215	\$845

**120421****2.5mm**

Finger Size	\$1,600 14kt Gold	\$1,600 10kt Gold
5	\$1,379	\$725
6	\$1,175	\$725
7	\$1,169	\$795
8	\$1,289	\$845
9	\$1,365	\$735
10	\$1,139	\$885
11	\$1,539	\$949
12	\$1,455	\$895



**Gold With a Silver Lining**

Precious Bond bands are made of 100% precious metal. The outer seamless band of 10kt gold is approximately 25% of the total weight. It is designed, finished, and uniquely fused to a sterling silver liner through high performance technology. The crafted piece is finished off with palladium and then a rhodium bond, keeping the finish intact with color and brilliance.

**Caring for Your Precious Bond Band**

Taking care of your Precious Bond band is the same as any other gold band. Because the outer surface of your band is a precious metal, it can be scratched. A jeweler can carefully polish the blemishes out and restore your band to its original state.

**Sizing Precious Bond Bands**

Your band is made of seamless, extruded gold and silver tubing, fused together without the application of any solder points. We highly recommend your professional jeweler use a one size stretching rule to avoid any "orange peeling." The band may NOT be cut and sized down.



Sample cross-sections:

**Domed Bands**

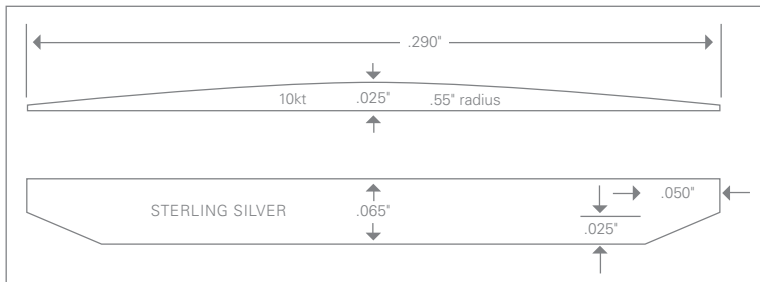

**Flat Bands**

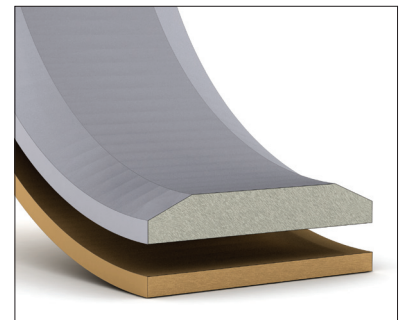
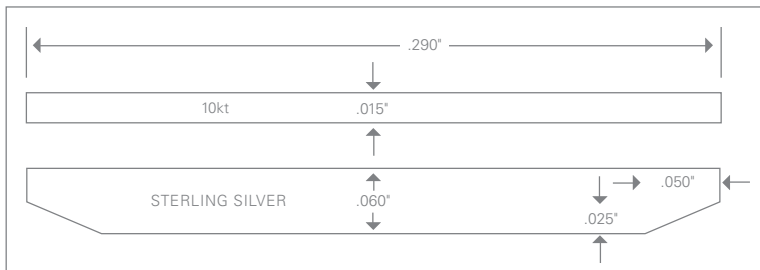



**650630** sterling silver/10kt  
0.06 ct tw 8mm  
size 7, \$445, 209, 3.22 dwt



**650631** sterling silver/10kt  
0.06 ct tw 8mm  
size 7, \$605, 209, 4.79 dwt



**51162** sterling silver/10kt  
5mm  
size 7, \$169, 3.18 dwt  
size 11, \$189, 3.54 dwt



**51167** sterling silver/10kt  
5mm  
size 7, \$175, 3.41 dwt  
size 11, \$195, 3.79 dwt



**51165** sterling silver/10kt  
7mm  
size 7, \$249, 4.08 dwt  
size 11, \$285, 4.79 dwt



**51161** sterling silver/10kt  
7mm  
size 7, \$265, 4.92  
size 11, \$289, 5.47

Most items available in any metal quality.

Suggested retail prices based on \$1,600 gold, \$1,700 platinum and \$30 silver. Visit [stuller.com](http://stuller.com) for our complete product selections and current pricing. | 415

DUO WEDDING BANDS



**11453** 14kt  
 $\frac{1}{8}$  ct tw (5- 2.3)  
 6.0 width, size 11  
 \$905, 3.34 dwt



**11539** 14kt  
 $\frac{1}{8}$  ct tw (3- 2.7)  
 6.3 width, size 11  
 \$1,205, 4.65 dwt



**120163** 14kt  
 $\frac{1}{10}$  ct tw (3- 2.0)  
 5.5 width, size 11  
 \$839, 3.19 dwt  
 FJ #67888



**11453** 14kt  
 $\frac{1}{8}$  ct tw (5- 2.0)  
 5.0 width, size 7  
 \$575, 2.00 dwt



**11539** 14kt  
 $\frac{1}{8}$  ct tw (3- 2.5)  
 6.0 width, size 7  
 \$775, 2.93 dwt



**120163** 14kt  
 $\frac{1}{10}$  ct tw (3- 2.0)  
 5.3 width, size 7  
 \$845, 3.21 dwt



**10971** 14kt  
 $\frac{1}{8}$  ct tw (3- 2.1)  
 6.5 width, size 11  
 \$1,045, 3.89 dwt  
 FJ #60133



**12560** 14kt two-tone  
 $\frac{1}{4}$  ct (1- 4.1)  
 6.5 width, size 11  
 \$1,515, 5.78 dwt  
 FJ #60129



**10972** 14kt  
 $\frac{1}{8}$  ct tw  
 (1- 2.4, 2- 2.2, 2- 2.0)  
 6.6 width, size 11  
 \$1,135, 4.37 dwt



**10971** 14kt  
 0.06 ct tw (3- 2.1)  
 4.0 width, size 7  
 \$685, 2.44 dwt



**12560** 14kt two-tone  
 $\frac{1}{8}$  ct (1- 3.5)  
 5.5 width, size 7  
 \$1,019, 3.79 dwt  
 FJ #60129



**10972** 14kt  
 $\frac{1}{8}$  ct tw  
 (1- 2.2, 2- 2.0, 2- 1.7)  
 5.2 width, size 7  
 \$719, 2.70 dwt



**11455** 14kt  
 $\frac{1}{10}$  ct tw (5- 1.7)  
 6.5 width, size 11  
 \$1,035, 3.85 dwt  
 FJ #60132



**12056** 14kt two-tone  
 $\frac{1}{4}$  ct tw (9- 2.0)  
 7.0 width, size 11  
 \$989, 5.16 dwt  
 FJ #63894



**121063** 14kt two-tone  
 $\frac{1}{8}$  ct tw (5- 2.2)  
 7.0 width, size 11  
 \$989, 5.16 dwt  
 FJ #63898



**11455** 14kt  
 $\frac{1}{10}$  ct tw  
 (3- 1.7, 2- 1.5)  
 4.5 width, size 7  
 \$585, 2.05 dwt  
 FJ #60132



**12056** 14kt two-tone  
 $\frac{1}{4}$  ct tw (9- 2.0)  
 7.0 width, size 7  
 \$855, 3.49 dwt  
 FJ #63894



**121063** 14kt two-tone  
 $\frac{1}{8}$  ct tw (5- 2.2)  
 7.0 width, size 7  
 \$855, 4.40 dwt  
 FJ #63898

DUO WEDDING BANDS



**120857** 14kt  
½ ct tw (8- 2.5)  
6.0 width, size 11  
\$1,275, 4.82 dwt  
FJ #63349



**121069** 14kt  
¼ ct tw (3- 2.2)  
7.0 width, size 11  
\$1,119, 6.06 dwt  
FJ #63902



**120859** 14kt  
½ ct tw (8- 2.5)  
4.0 width, size 11  
\$925, 3.42 dwt



**120856** 14kt  
½ ct tw (8- 2.5)  
6.0 width, size 11  
\$1,535, 5.99 dwt



**120857** 14kt  
½ ct tw (8- 2.5)  
6.0 width, size 7  
\$1,079, 4.03 dwt  
FJ #63349



**121069** 14kt  
¼ ct tw (3- 2.2)  
7.0 width, size 7  
\$959, 5.17 dwt  
FJ #63902



**120859** 14kt  
½ ct tw (8- 2.5)  
4.0 width, size 7  
\$805, 2.93 dwt



**120856** 14kt  
½ ct tw (8- 2.5)  
6.0 width, size 7  
\$1,339, 5.19 dwt



**120858** 14kt  
½ ct tw (8- 2.5)  
8.0 width, size 11  
\$1,755, 8.95 dwt



**121057** 14kt two-tone  
¼ ct tw (3- 2.4)  
7.0 width, size 11  
\$1,175, 6.10 dwt  
FJ #63896



**121064** 14kt  
¼ ct tw (3- 2.3)  
7.0 width, size 11  
\$1,315, 7.02 dwt  
FJ #63899



**120858** 14kt  
½ ct tw (8- 2.5)  
8.0 width, size 7  
\$1,535, 7.91 dwt



**121057** 14kt two-tone  
¼ ct tw (3- 2.4)  
7.0 width, size 7  
\$1,019, 5.21 dwt  
FJ #63896



**121064** 14kt  
¼ ct tw (3- 2.3)  
7.0 width, size 7  
\$1,135, 6.00 dwt  
FJ #63899



**121068** 14kt two-tone  
¼ ct tw (3- 2.8)  
7.0 width, size 11  
\$1,329, 7.08 dwt  
FJ #63901



**120392** 14kt  
½ ct tw (8- 2.2)  
10.0 width, size 11  
\$2,189, 8.62 dwt  
FJ #62235



**120833** 14kt  
½ ct tw (12- 2.0)  
7.0 width, size 11  
\$1,415, 5.50 dwt



**121068** 14kt two-tone  
¼ ct tw (3- 2.8)  
7.0 width, size 7  
\$1,145, 6.04 dwt  
FJ #63901



**120392** 14kt  
½ ct tw (8- 2.2)  
9.5 width, size 7  
\$1,689, 6.62 dwt  
FJ #62235



**120833** 14kt  
½ ct tw (12- 2.0)  
7.0 width, size 7  
\$1,009, 3.87 dwt

Most items available in any metal quality.

Suggested retail prices based on \$1,600 gold, \$1,700 platinum and \$30 silver. Visit [stuller.com](http://stuller.com) for our complete product selections and current pricing. | 417

## DUO WEDDING BANDS



**12084** 14kt  
 $\frac{1}{3}$  ct tw (5- 2.7)  
 7.0 width, size 11  
 \$1,125, 4.22 dwt  
 FJ #60137



**10342** 14kt  
 $\frac{3}{4}$  ct tw  
 (1- 4.0, 2- 3.4, 2- 3.0)  
 10.0 width, size 11  
 \$1,489, 5.68 dwt



**12089** 14kt  
 $\frac{1}{3}$  ct tw (1- 2.7, 4- 2.5)  
 9.0 width, size 11  
 \$1,415, 5.50 dwt  
 FJ #67889



**12084** 14kt  
 $\frac{1}{3}$  ct tw (5- 2.7)  
 5.0 width, size 7  
 \$675, 2.39 dwt



**10343** 14kt  
 $\frac{3}{4}$  ct tw  
 (1- 4.0, 2- 3.4, 2- 3.0)  
 10.0 width, size 7  
 \$1,405, 5.34 dwt



**12081** 14kt  
 $\frac{3}{8}$  ct tw  
 (2- 2.4, 2- 2.2, 2- 3.0)  
 8.0 width, size 7  
 \$1,065, 4.10 dwt



**10881** 14kt  
 $\frac{1}{2}$  ct tw (5- 3.0)  
 4.4 width, size 11  
 \$985, 3.77 dwt  
 FJ #67886



**10882** 14kt  
 $\frac{5}{8}$  ct tw (5- 3.2)  
 5.0 width, size 11  
 \$1,099, 4.23 dwt  
 FJ #60140



**10885** 14kt  
 $\frac{3}{4}$  ct tw (5- 3.4)  
 5.3 width, size 11  
 \$1,395, 5.31 dwt  
 FJ #67885



**10881** 14kt  
 $\frac{1}{2}$  ct tw (5- 3.0)  
 4.0 width, size 7  
 \$785, 2.96 dwt



**10882** 14kt  
 $\frac{5}{8}$  ct tw (5- 3.2)  
 4.0 width, size 7  
 \$1,085, 4.18 dwt  
 FJ #60140



**10885** 14kt  
 $\frac{3}{4}$  ct tw (5- 3.4)  
 4.3 width, size 7  
 \$1,229, 4.64 dwt



**10880** 14kt  
 1 ct tw (5- 3.8)  
 5.5 width, size 11  
 \$1,365, 5.17 dwt  
 FJ #60141



**11541** 14kt  
 $\frac{1}{2}$  ct tw  
 (5- 2.0, 2- 1.7)  
 6.0 width, size 11  
 \$1,039, 3.87 dwt



**10975** 14kt  
 $\frac{1}{3}$  ct tw (7- 2.0)  
 7.0 width, size 11  
 \$1,165, 4.37 dwt  
 FJ #60138



**10880** 14kt  
 1 ct tw (5- 3.8)  
 5.0 width, size 7  
 \$1,215, 4.57 dwt



**11541** 14kt  
 $\frac{1}{8}$  ct tw (7- 1.5)  
 5.5 width, size 7  
 \$575, 2.00 dwt



**10975** 14kt  
 $\frac{1}{8}$  ct tw (7- 1.7)  
 6.5 width, size 7  
 \$895, 3.29 dwt



**12555** 14kt two-tone  
 $\frac{3}{8}$  ct tw (6- 3.0)  
 6.0 width, size 11  
 \$2,145, 8.29 dwt  
 FJ #60135



**9610** 14kt two-tone  
 $\frac{1}{2}$  ct tw (5- 3.0)  
 7.0 width, size 11  
 \$1,459, 5.57 dwt  
 FJ #60136



**9609** 14kt two-tone  
 $\frac{1}{2}$  ct tw (5- 3.0)  
 7.0 width, size 11  
 \$1,635, 6.26 dwt  
 FJ #60694



**12555** 14kt two-tone  
 $\frac{1}{4}$  ct tw (6- 2.2)  
 5.5 width, size 7  
 \$1,015, 3.73 dwt  
 FJ #60135



**12549** 14kt two-tone  
 $\frac{1}{3}$  ct tw (5- 2.5)  
 6.0 width, size 7  
 \$1,095, 4.05 dwt  
 Also available in  $\frac{1}{2}$  ct tw.



**12581** 14kt two-tone  
 $\frac{1}{3}$  ct tw (5- 2.5)  
 5.5 width, size 7  
 \$815, 2.97 dwt  
 FJ #60224

DUO WEDDING BANDS



**121156** 14kt two-tone  
½ ct tw (5- 3.0)  
6.0 width, size 11  
\$1,555, 7.00 dwt  
FJ #64123



**121158** 14kt two-tone  
½ ct tw (7- 2.0)  
8.0 width, size 11  
\$1,739, 8.85 dwt  
FJ #64125



**121155** 14kt two-tone  
¾ ct tw (5- 3x3)  
6.0 width, size 11  
\$1,625, 7.30 dwt  
FJ #64122



**121156** 14kt two-tone  
½ ct tw (5- 3.0)  
6.0 width, size 7  
\$1,455, 6.50 dwt  
FJ #64123



**121158** 14kt two-tone  
½ ct tw (7- 2.0)  
7.7 width, size 7  
\$1,245, 5.60 dwt  
FJ #64125



**121155** 14kt two-tone  
½ ct tw (5- 2.5x2.5)  
6.0 width, size 7  
\$1,405, 6.30 dwt  
FJ #64122



**12559** 14kt two-tone  
½ ct tw (3- 2.5x2.5)  
6.5 width, size 11  
\$1,769, 6.80 dwt  
FJ #60134



**12582** 14kt two-tone  
½ ct tw (3- 2.5x2.5)  
6.5 width, size 11  
\$1,795, 6.89 dwt  
FJ #60130



**120146** 14kt  
½ ct tw (3- 2.25x2.25)  
6.3 width, size 11  
\$1,075, 4.14 dwt



**12559** 14kt two-tone  
½ ct tw (3- 2.5x2.5)  
5.5 width, size 7  
\$1,009, 3.74 dwt  
FJ #60134



**12582** 14kt two-tone  
½ ct tw (3- 2.5x2.5)  
4.3 width, size 7  
\$939, 3.46 dwt  
FJ #60130



**120146** 14kt  
½ ct tw (3- 2.25x2.25)  
4.8 width, size 7  
\$739, 2.79 dwt



**120707** 14kt two-tone  
1.02 ct tw (6- 3x3)  
8.3 width, size 11  
\$1,765, 6.79 dwt  
FJ #67891



**120848** 14kt  
½ ct tw (9- 2.5x1.75)  
6.0 width, size 11  
\$1,795, 6.90 dwt  
FJ #63472



**10357** 14kt  
1¼ ct tw (18- 3.5x2)  
5.0 width, size 11  
\$1,095, 4.21 dwt



**120707** 14kt two-tone  
1.02 ct tw (6- 3x3)  
6.5 width, size 7  
\$1,299, 4.91 dwt



**120848** 14kt  
½ ct tw (9- 2.5x1.75)  
6.0 width, size 7  
\$1,549, 5.93 dwt  
FJ #63472



**10357** 14kt  
1½ ct tw (13- 2.75x2  
2- 2.5x1.75), 4.0 width  
size 7, \$795, 3.01 dwt  
FJ #61295



**120891** 14kt  
¼ ct tw (10- 1.5  
10- 1.3)  
14.3 width, size 11  
\$2,565, 10.00 dwt



**120895** 14kt two-tone  
¼ ct tw (10- 1.5  
10- 1.3)  
14.0 width, size 11  
\$2,469, 9.75 dwt



**5144** 14kt  
12.5 width  
size 11  
\$2,115, 7.47 dwt



**120891** 14kt  
¼ ct tw (15- 1.3, 8- 1.2)  
12.8 width, size 7  
\$1,699, 6.52 dwt



**120895** 14kt two-tone  
¼ ct tw (15-1.3, 8-1.2)  
12.8 width, size 7  
\$1,745, 6.82 dwt



**5144** 14kt  
11.8 width, size 7  
\$1,865, 6.65 dwt

Most items available in any metal quality.

Suggested retail prices based on \$1,600 gold, \$1,700 platinum and \$30 silver. Visit [stuller.com](http://stuller.com) for our complete product selections and current pricing. | 419

## DUO WEDDING BANDS



**5881** 14kt two-tone  
12.5 width, size 11  
\$2,205, 8.53 dwt



**120681** 14kt  
0.04 ct tw (8- 1.0)  
16.0 width, size 11  
\$1,439, 5.60 dwt  
FJ #64141



**120682** 14kt  
0.07 ct tw (7- 1.2)  
14.0 width, size 11  
\$1,505, 5.87 dwt  
FJ #64142



**5881** 14kt two-tone  
12.5 width, size 7  
\$1,785, 6.69 dwt



**120681** 14kt  
0.04 ct tw (8- 1.0)  
15.3 width, size 7  
\$929, 3.55 dwt  
FJ #64141



**120682** 14kt  
0.07 ct tw (7- 1.2)  
14.0 width, size 7  
\$1,085, 4.17 dwt  
FJ #64142



**9423** 14kt  
11.0 width, size 11  
\$1,225, 5.15 dwt



**9423** 14kt  
11.0 width, size 11  
\$1,225, 5.15 dwt



**50296** 14kt two-tone  
13.3 width, size 11  
\$875, 3.65 dwt



**10584** 14kt  
12.0 width, size 7  
\$515, 1.75 dwt



**10583** 14kt  
10.5 width, size 7  
\$825, 3.57 dwt



**50296** 14kt two-tone  
13.0 width, size 7  
\$785, 3.26 dwt



**50349** 14kt two-tone  
13.3 width, size 11  
\$1,505, 6.03 dwt



**50435** 14kt  
15.8 width, size 11  
\$1,185, 4.91 dwt



**50406** 14kt  
13.0 width, size 11  
\$1,059, 4.57 dwt



**50349** 14kt two-tone  
13.3 width, size 7  
\$1,025, 4.25 dwt



**50435** 14kt  
14.0 width, size 7  
\$875, 3.72 dwt



**50406** 14kt  
11.3 width, size 7  
\$809, 3.44 dwt



**50297** 14kt  
8.3 width, size 11  
\$1,595, 6.69 dwt



**50570** 14kt two-tone  
7.0 width, size 11  
\$1,075, 4.71 dwt



**50297** 14kt  
8.0 width, size 7  
\$1,179, 4.89 dwt



**50570** 14kt two-tone  
7.0 width, size 7  
\$929, 4.78 dwt

DUO WEDDING BANDS



**50100** 14kt  
6.0 width, size 11  
\$1,539, 5.89 dwt



**5768** 14kt  
6.5 width, size 11  
\$1,515, 5.90 dwt



**50650** platinum  
7.0 width, size 11  
\$2,365, 5.70 dwt



**50100** 14kt  
6.0 width, size 7  
\$1,365, 5.03 dwt



**5768** 14kt  
6.5 width, size 7  
\$1,179, 4.55 dwt



**50650** platinum  
3.5 width, size 7  
\$1,935, 4.61 dwt



**5794** 14kt two-tone  
5.5 width, size 11  
\$945, 3.67 dwt



**10610** 14kt  
5.0 width, size 11  
\$729, 3.15 dwt



**5795** 14kt two-tone  
7.0 width, size 11  
\$1,359, 5.48 dwt



**5794** 14kt two-tone  
3.5 width, size 7  
\$595, 2.09 dwt



**10610** 14kt  
5.0 width, size 7  
\$625, 2.68 dwt



**5795** 14kt two-tone  
6.0 width, size 7  
\$725, 2.89 dwt



**5770** 14kt two-tone  
7.0 width, size 11  
\$1,409, 5.70 dwt



**5771** 14kt two-tone  
5.0 width, size 11  
\$969, 3.78 dwt



**50980** 14kt two-tone  
7.0 width, size 11  
\$1,265, 3.76 dwt



**5770** 14kt two-tone  
6.0 width, size 7  
\$879, 3.57 dwt



**5771** 14kt two-tone  
3.5 width, size 7  
\$645, 2.30 dwt



**50980** 14kt two-tone  
7.0 width, size 7  
\$1,095, 3.25 dwt



**50981** 14kt two-tone  
8.0 width, size 11  
\$1,375, 4.16 dwt



**50982** 14kt two-tone  
8.0 width, size 11  
\$1,245, 3.70 dwt



**50984** 14kt  
5.0 width, size 11  
\$1,329, 4.02 dwt



**50981** 14kt two-tone  
8.0 width, size 7  
\$1,205, 3.25 dwt



**50982** 14kt two-tone  
8.0 width, size 7  
\$1,075, 3.20 dwt



**50984** 14kt  
5.0 width, size 7  
\$1,159, 3.45 dwt

Most items available in any metal quality.

Suggested retail prices based on \$1,600 gold, \$1,700 platinum and \$30 silver. Visit [stuller.com](http://stuller.com) for our complete product selections and current pricing. | 421



## ROLLING RING BANDS

### 3-Band Rolling Ring

2.5 width each band



**5620** 14kt  
2.5 width, size 11  
\$909, 4.40 dwt



**5621** 14kt tri-color  
2.5 width, size 11  
\$879, 4.42 dwt



**5692** 18kt/platinum  
2.5 width, size 11  
\$1,689, 5.84 dwt



**5620** 14kt  
2.5 width, size 7  
\$805, 3.97 dwt



**5621** 14kt tri-color  
2.5 width, size 7  
\$795, 3.88 dwt



**5692** 18kt/platinum  
2.5 width, size 7  
\$1,489, 5.18 dwt

### 6-Band Rolling Ring

1.5 width each band



**5726** 14kt  
1.5 width, size 11  
\$779, 3.61 dwt



**5726** 14kt  
1.5 width, size 7  
\$695, 3.20 dwt

## FANCY WEDDING BANDS



**50983** 14kt  
8.0 width, size 11  
\$2,195, 6.64 dwt



**5117** 14kt  
6.5 width, size 11  
\$1,149, 4.83 dwt



**50519** 14kt  
7.0 width, size 11  
\$1,745, 8.54 dwt



**50983** 14kt  
8.0 width, size 7  
\$1,885, 5.70 dwt



**5120** 14kt  
6.2 width, size 7  
\$785, 3.41 dwt



**50519** 14kt  
7 width, size 7  
\$1,555, 7.49 dwt



**5097** 14kt  
10.0 width, size 11  
\$855, 3.72 dwt



**4508** 14kt  
7.0 width, size 11  
\$1,065, 4.67 dwt



**50285** 14kt  
10.0 width, size 11  
\$1,775, 7.53 dwt



**5097** 14kt  
7.0 width, size 7  
\$759, 3.30 dwt



**4508** 14kt  
7.0 width, size 7  
\$1,119, 4.71 dwt



**50285** 14kt  
10.0 width, size 7  
\$1,425, 6.03 dwt

PRECIOUS METAL WEDDING BANDS



**50963**

2.68 width, 1.54 dwt  
sterling silver, \$49  
black rhodium-plated, \$65  
yellow gold-plated, \$55  
rose gold-plated, \$55



**50959**

2.7 width, 1.74 dwt  
sterling silver, \$49  
black rhodium-plated, \$65  
yellow gold-plated, \$55  
rose gold-plated, \$55



**50958**

3.2 width, 1.61 dwt  
sterling silver, \$55  
black rhodium-plated, \$75  
yellow gold-plated, \$59  
rose gold-plated, \$55



50944	width	dwt	\$
sterling silver	3.0	1.17	\$69
14kt yellow	3.0	1.45	\$409



50936	width	dwt	\$
sterling silver	3.2	2.05	\$179
14kt yellow	3.2	2.91	\$769



50926	width	dwt	\$
sterling silver	3.5	1.47	\$69
14kt yellow	3.5	1.83	\$505



50927	width	dwt	\$
sterling silver	3.5	1.58	\$75
14kt yellow	3.5	1.97	\$535



50928	width	dwt	\$
sterling silver	2.8	1.54	\$75
14kt yellow	2.8	1.92	\$525



50467	width	dwt	\$
14kt white	2.75	3.65	\$985
14kt yellow	2.75	3.65	\$955
14kt rose	2.75	3.55	\$929



50468	width	dwt	\$
14kt white	3.0	3.49	\$945
14kt yellow	3.0	3.49	\$915
14kt rose	3.0	3.71	\$969



10557	width	dwt	\$
14kt white	3.0	1.82	\$529
14kt yellow	3.0	1.82	\$499



10559	width	dwt	\$
14kt white	3.0	1.99	\$569
14kt yellow	3.0	1.99	\$539



50381	width	dwt	\$
14kt white	4.3	4.98	\$1,199
14kt yellow	4.3	4.98	\$1,179
14kt rose	4.3	5.48	\$1,315

Most items available in any metal quality.

Suggested retail prices based on \$1,600 gold, \$1,700 platinum and \$30 silver. Visit [stuller.com](http://stuller.com) for our complete product selections and current pricing. | 423

## COMFORT-FIT FANCY BANDS



**5991** 14kt two-tone  
4.0 width, size 11  
\$635, 3.16 dwt

**5991** 14kt two-tone  
4.0 width, size 7  
\$555, 2.75 dwt



**5684** 14kt two-tone  
6.0 width, size 11  
\$939, 5.10 dwt

**5684** 14kt two-tone  
6.0 width, size 7  
\$809, 4.36 dwt



**5721** 14kt two-tone  
5.5 width, size 11  
\$949, 5.29 dwt  
18kt yellow/platinum  
#5696

**5721** 14kt two-tone  
5.5 width, size 7  
\$819, 4.51 dwt



**5968** 14kt two-tone  
8.0 width, size 11  
\$1,419, 7.69 dwt

**5968** 14kt two-tone  
8.0 width, size 7  
\$1,225, 6.55 dwt



**5975** 14kt two-tone  
6.0 width, size 11  
\$1,009, 5.55 dwt  
18kt yellow/platinum  
#5974

**5975** 14kt two-tone  
6.0 width, size 7  
\$855, 4.76 dwt



**5720** 14kt two-tone  
6.0 width, size 11  
\$969, 5.30 dwt  
18kt yellow/platinum  
#5691

**5720** 14kt two-tone  
6.0 width, size 7  
\$825, 4.48 dwt



**5724** 14kt two-tone  
4.0 width, size 11  
\$699, 3.71 dwt  
18kt yellow/platinum  
#5686

**5724** 14kt two-tone  
4.0 width, size 7  
\$605, 3.20 dwt



**50165** 14kt  
5.0 width, size 11  
\$885, 4.83 dwt

**50165** 14kt  
5.0 width, size 7  
\$759, 4.13 dwt



**50672** 14kt  
4.0 width, size 11  
\$575, 3.08 dwt

**50672** 14kt  
4.0 width, size 7  
\$495, 2.64 dwt



**5980** 14kt two-tone  
4.0 width, size 11  
\$605, 3.16 dwt  
18kt yellow/platinum  
#5981

**5980** 14kt two-tone  
4.0 width, size 7  
\$519, 2.70 dwt



**50137** 14kt two-tone  
4.0 width, size 11  
\$599, 3.19 dwt

**50137** 14kt two-tone  
4.0 width, size 7  
\$515, 2.72 dwt



**5977** 14kt  
6.0 width, size 11  
\$1,365, 5.51 dwt

**5977** 14kt  
6.0 width, size 7  
\$1,165, 4.70 dwt



**5793** 14kt two-tone  
6.0 width, size 11  
\$1,095, 6.00 dwt

**5793** 14kt two-tone  
6.0 width, size 7  
\$945, 5.14 dwt



**5971** 14kt two-tone  
7.5 width, size 11  
\$1,119, 6.11 dwt  
18kt yellow/platinum  
Series #5969

**5971** 14kt two-tone  
7.5 width, size 7  
\$959, 5.26 dwt



**5976** 14kt two-tone  
6.0 width, size 11  
\$1,079, 5.81 dwt  
18kt yellow/platinum  
Series #5690

**5976** 14kt two-tone  
6.0 width, size 7  
\$895, 4.60 dwt



**5722** 14kt two-tone  
6.0 width, size 11  
\$1,085, 5.61 dwt  
18kt yellow/platinum  
Series #5688

**5722** 14kt two-tone  
6.0 width, size 7  
\$949, 4.76 dwt



**50583** 14kt  
7.5 width, size 11  
\$1,095, 6.02 dwt

**50583** 14kt  
7.5 width, size 7  
\$945, 5.14 dwt



**50138** 14kt two-tone  
7.5 width, size 11  
\$1,109, 6.12 dwt

**50138** 14kt two-tone  
7.5 width, size 7  
\$955, 5.24 dwt



**50075** 14kt two-tone  
7.0 width, size 11  
\$1,199, 6.44 dwt

**50075** 14kt two-tone  
7.0 width, size 7  
\$1,009, 5.30 dwt



**50425** 14kt two-tone  
7.0 width, size 11  
\$1,275, 6.59 dwt

**50425** 14kt two-tone  
7.0 width, size 7  
\$1,109, 5.64 dwt



**50181** 14kt  
6.8 width, size 11  
\$1,135, 6.30 dwt

**50181** 14kt  
6.8 width, size 7  
\$995, 5.48 dwt



**5717** 14kt  
6.0 width, size 11  
\$979, 5.50 dwt

**5717** 14kt  
6.0 width, size 7  
\$865, 4.84 dwt



**5838** 14kt two-tone  
6.0 width, size 11  
\$1,005, 4.38 dwt

**5838** 14kt two-tone  
6.0 width, size 7  
\$865, 3.63 dwt



**5947** 14kt two-tone  
6.3 width, size 11  
\$1,005, 4.63 dwt

**5947** 14kt two-tone  
6.3 width, size 7  
\$885, 4.01 dwt

COMFORT-FIT FANCY BANDS



**50676** 14kt  
6.0 width, size 11  
\$1,119, 5.66 dwt



**5948** 14kt two-tone  
6.0 width, size 11  
\$1,079, 5.00 dwt



**5715** 14kt two-tone  
6.0 width, size 11  
\$1,165, 5.69 dwt



**50646** 14kt  
6.0 width, size 11  
\$1,189, 6.33 dwt



**5728** 14kt two-tone  
6.0 width, size 11  
\$1,005, 4.64 dwt



**50674** 14kt  
4.0 width, size 11  
\$749, 3.60 dwt

**50676** 14kt  
6.0 width, size 7  
\$975, 4.84 dwt

**5948** 14kt two-tone  
6.0 width, size 7  
\$915, 4.02 dwt

**5715** 14kt two-tone  
6.0 width, size 7  
\$1,015, 4.91 dwt

**50646** 14kt  
6.0 width, size 7  
\$1,029, 5.43 dwt

**5728** 14kt two-tone  
6.0 width, size 7  
\$875, 3.92 dwt

**50674** 14kt  
4.0 width, size 7  
\$659, 3.08 dwt



**5955** 14kt two-tone  
4.0 width, size 11  
\$739, 3.19 dwt



**50082** 14kt two-tone  
7.0 width, size 11  
\$1,189, 5.65 dwt



**50427** 14kt  
3.0 width, size 11  
\$659, 3.01 dwt



**50316** 14kt two-tone  
6.8 width, size 11  
\$1,269, 6.50 dwt



**50423** 14kt two-tone  
6.0 width, size 11  
\$1,165, 6.17 dwt



**50315** 14kt two-tone  
6.8 width, size 11  
\$1,269, 6.50 dwt

**5955** 14kt two-tone  
4.0 width, size 7  
\$659, 2.77 dwt

**50082** 14kt two-tone  
7.0 width, size 7  
\$995, 4.60 dwt

**50427** 14kt  
3.0 width, size 7  
\$575, 2.56 dwt

**50316** 14kt two-tone  
6.8 width, size 7  
\$1,105, 5.57 dwt

**50423** 14kt two-tone  
6.0 width, size 7,  
\$999, 5.26 dwt

**50315** 14kt two-tone  
6.8 width, size 7  
\$1,105, 5.57 dwt



**5967** 14kt two-tone  
7.0 width, size 11  
\$1,185, 5.47 dwt



**50309** 14kt  
6.8 width, size 11  
\$1,249, 6.51 dwt



**50184** 14kt  
7.0 width, size 11  
\$1,085, 5.96 dwt



**50154** platinum  
7.0 width, size 11  
\$3,929, 10.93 dwt



**50648** 14kt  
7.0 width, size 11  
\$855, 6.41 dwt



**50411** 14kt two-tone  
7.0 width, size 11  
\$1,275, 6.50 dwt

**5967** 14kt two-tone  
7.0 width, size 7  
\$999, 4.66 dwt

**50309** 14kt  
6.8 width, size 7  
\$1,085, 5.57 dwt

**50184** 14kt  
7.0 width, size 7  
\$945, 5.15 dwt

**50154** platinum  
7.0 width, size 7  
\$3,395, 9.36 dwt

**50648** 14kt  
7.0 width, size 7  
\$735, 5.48 dwt

**50411** 14kt two-tone  
7.0 width, size 7  
\$1,109, 5.57 dwt



**50308** 14kt two-tone  
7.0 width, size 11  
\$1,275, 6.50 dwt



**50979** 14kt  
7.0 width, size 11  
\$1,795, 6.00 dwt



**50975** 14kt  
7.0 width, size 11  
\$1,665, 5.56 dwt



**50977** 14kt  
7.0 width, size 11  
\$1,745, 5.83 dwt



**50978** 14kt  
7.0 width, size 11  
\$1,765, 5.90 dwt

**50308** 14kt two-tone  
7.0 width, size 7  
\$1,109, 5.57 dwt

**50979** 14kt  
7.0 width, size 7  
\$1,545, 5.15 dwt

**50975** 14kt  
7.0 width, size 7  
\$1,429, 4.77 dwt

**50977** 14kt  
7.0 width, size 7  
\$1,495, 5.00 dwt

**50978** 14kt  
7.0 width, size 7  
\$1,515, 5.06 dwt

Most items available in any metal quality.

Suggested retail prices based on \$1,600 gold, \$1,700 platinum and \$30 silver. Visit [stuller.com](http://stuller.com) for our complete product selections and current pricing. | 425

## 18KT AND PLATINUM WEDDING BANDS

Platinum and 18kt bonded bands are available for order in whole and half finger sizes 5-12.5. Sizing is not recommended.  
Platinum bands (single tone bands) are available for order in whole finger sizes 5-12 and can be sized.



**5772**  
18kt yellow/platinum  
3.5 width, size 11  
\$2,465, 7.33 dwt

**5772**  
18kt yellow/platinum  
3.5 width, size 7  
\$2,145, 6.24 dwt



**5699**  
18kt yellow/platinum  
6.0 width, size 11  
\$2,415, 8.50 dwt

**5699**  
18kt yellow/platinum  
6.0 width, size 7  
\$2,139, 7.41 dwt



**5793**  
18kt yellow/platinum  
6.0 width, size 11  
\$2,885, 7.84 dwt

**5793**  
18kt yellow/platinum  
6.0 width, size 7  
\$2,555, 6.58 dwt



**5981**  
18kt yellow/platinum  
4.0 width, size 11  
\$1,545, 4.82 dwt

**5981**  
18kt yellow/platinum  
4.0 width, size 7  
\$1,365, 4.17 dwt



**5851**  
18kt yellow/platinum  
7.0 width, size 11  
\$2,195, 7.27 dwt

**5851**  
18kt yellow/platinum  
7.0 width, size 7  
\$2,485, 8.28 dwt



**50138**  
18kt yellow/platinum  
7.5 width, size 11  
\$2,225, 7.76 dwt

**50138**  
18kt yellow/platinum  
7.5 width, size 7  
\$1,925, 6.63 dwt



**5690**  
18kt yellow/platinum  
6.0 width, size 11  
\$2,099, 6.82 dwt

**5690**  
18kt yellow/platinum  
6.0 width, size 7  
\$1,869, 6.08 dwt



**50164**  
18kt yellow/platinum  
5.0 width, size 11  
\$1,935, 6.01 dwt

**50164**  
18kt yellow/platinum  
5.0 width, size 7  
\$1,669, 5.03 dwt



**50166**  
18kt yellow/platinum  
6.0 width, size 11  
\$2,365, 7.76 dwt

**50166**  
18kt yellow/platinum  
6.0 width, size 7  
\$2,099, 6.94 dwt



**5686**  
18kt yellow/platinum  
4.0 width, size 11  
\$1,445, 4.57 dwt

**5686**  
18kt yellow/platinum  
4.0 width, size 7  
\$1,225, 3.90 dwt



**5983**  
platinum  
4.0 width, size 11  
\$3,645, 6.04 dwt

**5983**  
platinum  
4.0 width, size 7  
\$3,209, 5.31 dwt



**5685**  
18kt yellow/platinum  
3.5 width, size 11  
\$1,239, 3.57 dwt

**5685**  
18kt yellow/platinum  
3.5 width, size 7  
\$1,105, 3.06 dwt

18KT AND PLATINUM WEDDING BANDS



**5684**  
18kt yellow/platinum  
6.0 width, size 11  
\$1,809, 5.99 dwt

**5684**  
18kt yellow/platinum  
6.0 width, size 7  
\$1,655, 5.46 dwt



**50168**  
18kt yellow/platinum  
6.0 width, size 11  
\$2,065, 6.21 dwt

**50168**  
18kt yellow/platinum  
6.0 width, size 7  
\$1,685, 5.35 dwt



**50152**  
platinum  
6.0 width, size 11  
\$3,505, 9.71 dwt

**50152**  
platinum  
6.0 width, size 7  
\$3,025, 8.29 dwt



**50078**  
18kt yellow/platinum  
7.0 width, size 11  
\$2,449, 8.7 dwt

**50078**  
18kt yellow/platinum  
7.0 width, size 7  
\$2,125, 7.42 dwt



**5967**  
18kt yellow/platinum  
7.0 width, size 11  
\$2,575, 7.24 dwt

**5967**  
18kt yellow/platinum  
7.0 width, size 7  
\$2,175, 5.92 dwt



**5962**  
18kt yellow/platinum  
7.0 width, size 11  
\$2,739, 9.46 dwt

**5962**  
18kt yellow/platinum  
7.0 width, size 7  
\$2,369, 8.06 dwt



**5955**  
18kt yellow/platinum  
4.0 width, size 11  
\$1,745, 5.83 dwt

**5955**  
18kt yellow/platinum  
4.0 width, size 7  
\$1,495, 4.93 dwt



**5947**  
18kt yellow/platinum  
6.3 width, size 11  
\$2,899, 9.72 dwt

**5947**  
18kt yellow/platinum  
6.3 width, size 7  
\$2,505, 8.23 dwt



**50082**  
18kt yellow/platinum  
7.0 width, size 11  
\$2,855, 10.20 dwt

**50082**  
18kt yellow/platinum  
7.0 width, size 7  
\$2,415, 8.49 dwt



**5732**  
18kt yellow/platinum  
6.0 width, size 11  
\$2,429, 7.40 dwt

**5732**  
18kt yellow/platinum  
6.0 width, size 7  
\$2,105, 6.31 dwt



**5689**  
18kt yellow/platinum  
6.0 width, size 11  
\$2,375, 8.24 dwt

**5689**  
18kt yellow/platinum  
6.0 width, size 7  
\$2,075, 7.11 dwt



**50106**  
platinum  
6.0 width, size 11  
\$3,389, 9.66 dwt

**50106**  
platinum  
6.0 width, size 7  
\$2,935, 8.27 dwt



**5766**  
18kt yellow/platinum  
6.3 width, size 11  
\$2,835, 8.06 dwt

**5766**  
18kt yellow/platinum  
6.0 width, size 7  
\$1,579, 4.16 dwt



**5850**  
platinum  
6.0 width, size 11  
\$3,849, 6.93 dwt

**5850**  
platinum  
6.0 width, size 7  
\$3,319, 5.92 dwt

## HAND ENGRAVED WEDDING BANDS

True hand engraving, once a cornerstone of fine jewelry ornamentation, is all but a lost art today. Skilled artisans tutored in classic old-world apprenticeship programs labor over each and every ring, in effect creating one-of-a-kind masterpieces. Single tone bands can be stretched up to  $\frac{3}{4}$  of a finger size with proper annealing, with the exception of series #50065. Half sizes can be special ordered and are non-returnable. Call for price and delivery.



**51096** 14kt  
2.0 width, size 11  
\$1,265, 2.13 dwt

**51096** 14kt  
2.0 width, size 7  
\$1,039, 1.70 dwt



**51098** 14kt  
2.0 width, size 11  
\$1,219, 2.13 dwt

**51098** 14kt  
2.0 width, size 7  
\$989, 1.70 dwt



**51104** 14kt  
2.0 width, size 11  
\$1,265, 2.13 dwt

**51104** 14kt  
2.0 width, size 7  
\$1,039, 1.70 dwt



**51101** 14kt  
2.0 width, size 11  
\$1,175, 2.13 dwt

**51101** 14kt  
2.0 width, size 7  
\$955, 1.70 dwt



**51100** 14kt  
3.0 width, size 11  
\$1,659, 2.57 dwt

**51100** 14kt  
3.0 width, size 7  
\$1,325, 2.05 dwt



**51099** 14kt  
3.0 width, size 11  
\$1,595, 2.57 dwt

**51099** 14kt  
3.0 width, size 7  
\$1,275, 2.05 dwt



**51103** 14kt  
3.0 width, size 11  
\$1,875, 2.57 dwt

**51103** 14kt  
3.0 width, size 7  
\$1,499, 2.05 dwt



**51102** 14kt  
3.0 width, size 11  
\$1,705, 2.57 dwt

**51102** 14kt  
3.0 width, size 7  
\$1,365, 2.05 dwt



**51097** 14kt  
3.0 width, size 11  
\$1,655, 2.57 dwt

**51097** 14kt  
3.0 width, size 7  
\$1,235, 2.05 dwt



**50093** 14kt  
3.0 width, size 11  
\$1,535, 2.56 dwt  
Also available in platinum

**50093** 14kt  
3.0 width, size 7  
\$1,275, 1.54 dwt



**50093** 14kt  
3.0 width, size 11  
\$1,535, 2.56 dwt  
Also available in platinum

**50093** 14kt  
3.0 width, size 7  
\$1,275, 1.34 dwt



**50058** 14kt two-tone  
4.0 width, size 11  
\$1,785, 3.45 dwt

**50058** 14kt two-tone  
4.0 width, size 7  
\$1,475, 2.82 dwt

## HAND-ENGRAVED WEDDING BANDS



**50196** 14kt  
6.0 width, size 11  
\$3,355, 6.1 dwt

**50196** 14kt  
6.0 width, size 7  
\$2,829, 5.1 dwt



**50196** 14kt  
6.0 width, size 11,  
\$3,205, 6.1 dwt

**50196** 14kt  
6.0 width, size 7,  
\$2,715, 5.1 dwt



**50062** 14kt  
6.0 width, size 11  
\$3,365, 4.51 dwt

**50062** 14kt  
6.0 width, size 7  
\$2,859, 4.51 dwt



**50092** 14kt two-tone  
5.8 width, size 11  
\$2,895, 5.54 dwt

**50092** 14kt two-tone  
5.8 width, size 7  
\$2,375, 5.67 dwt



**50055** 14kt two-tone  
6.0 width, size 11,  
\$2,955, 7.06 dwt

**50055** 14kt two-tone  
6.0 width, size 7,  
\$2,435, 4.59 dwt



**50066** 14kt  
6.0 width, size 11  
\$3,205, 6.24 dwt

**50066** 14kt  
6.0 width, size 7  
\$2,715, 4.86 dwt



**50061** 14kt  
6.0 width, size 11  
\$3,205, 5.38 dwt

**50061** 14kt  
6.0 width, size 7,  
\$2,715, 4.78 dwt



**50068** platinum  
6.0 width, size 11  
\$4,255, 6.28 dwt

**50068** platinum  
6.0 width, size 7  
\$3,585, 5.60 dwt



**50373** 14kt  
8.5 width, size 11  
\$3,365, 5.80 dwt

**50373** 14kt  
8.5 width, size 7  
\$2,689, 5.80 dwt



**50374** 14kt two-tone  
8.5 width, size 11  
\$3,365, 5.10 dwt

**50374** 14kt two-tone  
8.5 width, size 7  
\$2,689, 5.10 dwt



**50094** 14kt  
8.5 width, size 7  
\$2,739, 4.92 dwt



**50094** 14kt  
8.5 width, size 7  
\$2,739, 4.52 dwt



**50063** 14kt  
6.0 width, size 11  
\$3,055, 4.35 dwt

**50063** 14kt  
6.0 width, size 7  
\$2,599, 3.65 dwt



**50091** 14kt  
8.0 width, size 7  
\$2,085, 3.47 dwt



**50065** 14kt  
10.0 width, size 11  
\$3,539, 5.30 dwt

**50065** 14kt  
10.0 width, size 7  
\$2,905, 4.77 dwt



**50065** 14kt  
10.0 width, size 11  
\$3,539, 6.04 dwt

**50065** 14kt  
10.0 width, size 7  
\$2,905, 5.30 dwt



## HAND WOVEN WEDDING BANDS



**50051** 14kt  
6.5 width, size 11  
\$1,375, 6.38 dwt

**50051** 14kt  
6.5 width, size 7  
\$1,119, 5.20 dwt



**50630** 14kt two-tone  
6.0 width, size 11  
\$1,449, 6.74 dwt

**50630** 14kt two-tone  
6.0 width, size 7  
\$1,185, 5.49 dwt



**50634** 14kt  
6.8 width, size 11  
\$1,359, 6.32 dwt

**50634** 14kt  
6.8 width, size 7  
\$1,119, 5.20 dwt



**50052** 14kt  
6.0 width, size 11  
\$875, 4.05 dwt

**50052** 14kt  
6.0 width, size 7  
\$709, 3.30 dwt



**50122** 14kt tri-color  
5.5 width, size 11  
\$955, 4.42 dwt

**50122** 14kt tri-color  
5.5 width, size 7  
\$775, 3.60 dwt



**50628** 14kt  
6.5 width, size 11  
\$1,315, 6.10 dwt

**50628** 14kt  
6.5 width, size 7  
\$1,075, 4.98 dwt



**50127** 14kt  
3.8 width, size 11  
\$529, 2.46 dwt

**50127** 14kt  
3.8 width, size 7  
\$429, 2.00 dwt



**50128** 14kt two-tone  
3.5 width, size 11  
\$529, 2.46 dwt

**50128** 14kt two-tone  
3.5 width, size 7  
\$429, 2.00 dwt



**50129** 14kt two-tone  
4.5 width, size 11  
\$795, 3.68 dwt

**50129** 14kt two-tone  
4.5 width, size 7  
\$645, 3.00 dwt



**50130** 14kt tri-color  
4.5 width, size 11  
\$795, 3.68 dwt

**50130** 14kt tri-color  
4.6 width, size 7  
\$645, 3.00 dwt



**50633** 14kt  
6.8 width, size 11  
\$1,165, 5.42 dwt

**50633** 14kt  
6.8 width, size 7  
\$955, 4.42 dwt



**50636** 14kt two-tone  
6.8 width, size 11  
\$1,219, 5.66 dwt

**50636** 14kt two-tone  
6.8 width, size 7  
\$995, 4.61 dwt



**50133** 14kt tri-color  
5.0 width, size 11  
\$925, 4.30 dwt

**50133** 14kt tri-color  
5.0 width, size 7  
\$755, 3.50 dwt



**50632** 14kt tri-color  
7.8 width, size 11  
\$1,765, 8.21 dwt

**50632** 14kt tri-color  
7.8 width, size 7  
\$1,439, 6.69 dwt



**50985** 14kt two-tone  
8.0 width, size 11  
\$1,389, 4.70 dwt

**50985** 14kt two-tone  
8.0 width, size 7  
\$1,205, 4.00 dwt



**50635** 14kt  
6.8 width, size 11  
\$1,315, 6.11 dwt

**50635** 14kt  
6.8 width, size 7  
\$1,075, 4.98 dwt



**50121** 14kt  
8.0 width, size 11  
\$1,615, 7.49 dwt

**50121** 14kt  
8.0 width, size 7  
\$1,315, 6.10 dwt



**50989** 14kt  
7.0 width, size 11  
\$1,825, 6.18 dwt

**50989** 14kt  
7.0 width, size 7  
\$1,569, 5.31 dwt



**50987** 14kt  
7.5 width, size 11  
\$1,739, 5.89 dwt

**50987** 14kt  
7.5 width, size 7  
\$1,499, 5.07 dwt



**50988** 14kt  
6.5 width, size 11  
\$1,465, 4.95 dwt

**50988** 14kt  
6.5 width, size 7  
\$1,259, 4.26 dwt

HAND WOVEN WEDDING BANDS



**50631** 14kt two-tone  
5.0 width, size 11  
\$1,019, 4.73 dwt

**50631** 14kt two-tone  
5.0 width, size 7,  
\$835, 3.86 dwt



**50049** 14kt two-tone  
8.0 width, size 11  
\$1,715, 7.98 dwt

**50049** 14kt two-tone  
8.0 width, size 7  
\$1,399, 6.50 dwt



**50047** 14kt two-tone  
8.0 width, size 11  
\$1,795, 8.35 dwt

**50047** 14kt two-tone  
8.0 width, size 7  
\$1,465, 6.80 dwt



**50123** 14kt two-tone  
8.0 width, size 11  
\$1,715, 7.98 dwt

**50123** 14kt two-tone  
8.0 width, size 7  
\$1,399, 6.50 dwt



**50054** 14kt tri-color  
8.0 width, size 11  
\$1,505, 7.00 dwt

**50054** 14kt tri-color  
8.0 width, size 7  
\$1,225, 5.70 dwt



**50742** 14kt white/14kt rose  
8.0 width, size 11  
\$1,769, 8.22 dwt

**50742** 14kt white/14kt rose  
8.0 width, size 7  
\$1,419, 6.60 dwt



**50045** 14kt two-tone  
8.0 width, size 11  
\$1,585, 7.37 dwt

**50045** 14kt two-tone  
8.0 width, size 7  
\$1,295, 6.00 dwt



**50132** 14kt two-tone  
7.0 width, size 11  
\$1,295, 6.02 dwt

**50132** 14kt two-tone  
7.0 width, size 7  
\$1,055, 4.90 dwt

A. 50133 | B. 50975 | C. TAR445D | D. 50980



Most items available in any metal quality.

Suggested retail prices based on \$1,600 gold, \$1,700 platinum and \$30 silver.  
Visit [stuller.com](http://stuller.com) for our complete product selections and current pricing. | 431

## PRECIOUS METAL WEDDING BANDS



**4205** 14kt tri-color  
2.0 width, size 6  
\$1,355, 4.80 dwt



**50071** 14kt yellow  
3.0 width, size 11  
\$489, 1.98 dwt



**50071** 14kt white  
3.0 width, size 11  
\$489, 1.98 dwt



**50071** 14kt rose  
3.0 width, size 11  
\$495, 1.98 dwt



**50071** 14kt green  
3.0 width, size 11  
\$515, 1.98 dwt



**50071** platinum  
3.0 width, size 11  
\$2,079, 3.09 dwt

**50071** 14kt yellow  
3.0 width, size 7  
\$435, 1.72 dwt

**50071** 14kt white  
3.0 width, size 7  
\$439, 1.73 dwt

**50071** 14kt rose  
3.0 width, size 7  
\$445, 1.75 dwt

**50071** 14kt green  
3.0 width, size 7  
\$459, 1.73 dwt

**50071** platinum  
3.0 width, size 7  
\$1,875, 2.81 dwt



**50072** 14kt yellow  
3.0 width, size 7  
\$449, 1.83 dwt



**50072** 14kt white  
3.0 width, size 7  
\$475, 2.04 dwt



**50072** 14kt rose  
3.0 width, size 7  
\$455, 1.82 dwt



**50072** 14kt green  
3.0 width, size 7  
\$489, 1.98 dwt



**50072** platinum  
3.0 width, size 7  
\$1,935, 2.94 dwt



**5773** 14kt  
3.5 width, size 6  
\$615, 2.70 dwt



**50822** 14kt tri-color  
2.5 width, size 7  
\$545, 2.20 dwt



**255** 14kt  
2.0 width, size 7  
\$245, 0.92 dwt



**254** 14kt  
2.5 width, size 7  
\$459, 1.89 dwt



**4784** 14kt  
2.0 width, size 6  
\$345, 1.40 dwt



**5768** 14kt  
6.5 width, size 7  
\$1,209, 4.55 dwt



**5771** 14kt two-tone  
3.5 width, size 7  
\$645, 2.30 dwt



**10663** 14kt  
4.0 width, size 7  
\$345, 1.37 dwt



**50539** 14kt  
4.5 width, size 7  
\$649, 2.79 dwt

PRECIOUS METAL WEDDING BANDS



**50232** 14kt two-tone  
6.5 width, size 7.5  
\$1,605, 5.41 dwt



**5119** 14kt  
6.0 width, size 7  
\$775, 3.36 dwt



**50402** 14kt  
8.3 width, size 7  
\$1,639, 6.88 dwt



**50404** 14kt  
8.3 width, size 7  
\$1,759, 7.40 dwt



**50403** 14kt  
10.3 width, size 7  
\$2,025, 8.54 dwt



**50714** 14kt  
6.0 width, size 7  
\$1,125, 4.70 dwt



**50735** 14kt  
7.5 width, size 7  
\$1,229, 5.24 dwt



**50383** 14kt  
7.3 width, size 7  
\$1,435, 6.03 dwt



**50399** 14kt  
8.0 width, size 7  
\$1,455, 6.09 dwt



**50400** 14kt  
8.5 width, size 7  
\$1,795, 7.56 dwt



**5217** 14kt  
9.5 width, size 7  
\$939, 4.10 dwt



**50372** 14kt  
8.0 width, size 7  
\$1,155, 4.87 dwt



**50371** 14kt  
8.5 width, size 7  
\$835, 3.62 dwt



**50434** 14kt  
7.5 width, size 7  
\$1,575, 6.65 dwt



**50370** 14kt  
8.0 width, size 7  
\$1,675, 7.07 dwt

**Anniversaries**

YEAR	GIFT	YEAR	GIFT	YEAR	GIFT
1	Gold Jewelry	11	Turquoise	25	Silver Jubilee
2	Garnet (all colors)	12	Jade	30	Pearl Jubilee
3	Pearls	13	Citrine	35	Emerald
4	Blue Topaz	14	Opal	40	Ruby
5	Sapphires (all colors)	15	Ruby	50	Golden Jubilee
6	Amethyst	16	Peridot	55	Alexandrite
7	Onyx	17	Watches	60	Diamond Jubilee
8	Tourmaline (all colors)	18	Cat's Eye	75	Platinum
9	Lapis Lazuli	19	Aquamarine		
10	Diamond Jewelry	20	Emerald		

## TITANIUM BANDS

---



**T805**  
3.0 width, polished  
sizes 5-12.5, \$70



**T805 Black**  
3.0 width, polished  
sizes 5-12.5, \$90



**T805**  
6.0 width, polished  
sizes 5-13, \$70



**T805 Black**  
6.0 width, polished  
sizes 5-13, \$90



**T805**  
8.0 width, polished  
sizes 6-14, \$70



**T805 Black**  
8.0 width, polished  
sizes 6-14, \$90



**T805**  
10.0 width, polished  
sizes 6-14, \$70



**T805**  
12.0 width, polished  
sizes 6-14, \$70



**T812**  
4.0 width, flat band  
polished  
sizes 5-11, \$70



**T812**  
6.0 width, flat band  
polished  
sizes 6-12, \$70



**T812 Black**  
6.0 width, flat band  
polished  
sizes 6-12, \$90



**T812**  
8.0 width, flat band  
polished  
sizes 6-13, \$70



**T812 Black**  
8.0 width, flat band, polished  
sizes 6-13, \$90



**T840**  
6.0 width, milgrain band  
polished, sizes 5-13, \$90



**T840**  
8.0 width, milgrain band  
polished, sizes 6-12.5, \$90



**T841**

4.0 width, double milgrain band polished, sizes 5-12, \$110

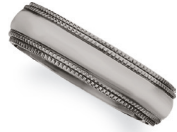

**T841**

6.0 width, double milgrain band polished, sizes 6-13, \$110



**T841 Black**

6.0 width, double milgrain band polished, sizes 6-13, \$130



**T841**

8.0 width, double milgrain band polished, sizes 6-13, \$110



**T893**

7.0 width, ridged band polished and satin-finished sizes 6-13, \$90



**T889**

7.0 width, beveled band polished and satin-finished sizes 7-13, \$90



**T811P**

7.0 width, ridged band polished, sizes 8-12, \$90



**T810**

7.0 width, ridged band polished, sizes 7-12, \$90



**T845**

6.0 width, grooved band polished and satin-finished sizes 8-13, \$90



**T1015**

7.0 width, grooved band polished and satin-finished sizes 7-13, \$90



**T809**

5.0 width, ridged band polished and oxidized sizes 6-11, \$110



**T816**

5.0 width polished and oxidized sizes 6-11, \$110



**T811**

7.0 width, ridged band polished and oxidized sizes 7-12, \$110



**T824**

7.5 width, ridged band polished and oxidized sizes 8-12, \$110



**T1000**

4.0 width, flat band polished and sandblasted sizes 5-11, \$90



**T998**

6.0 width polished and sandblasted sizes 6-11, \$109

## TITANIUM BANDS



**T901**  
7.0 width, grooved band  
polished and satin-finished  
sizes 6-13, \$90



**T958**  
5.0 width, ridged band  
polished and satin-finished  
sizes 6-11, \$90



**T891**  
7.0 width, grooved band  
polished and satin-finished  
sizes 7-13, \$90

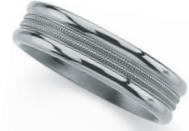

**T850**  
6.0 width, grooved and  
milgrained band, polished  
sizes 7-13, \$110



**T897**  
7.0 width, milgrain band  
polished  
sizes 7-13, \$130



**T990**  
7.0 width, milgrain band  
polished and diamond cut  
sizes 6-11, \$150



**T935**  
7.0 width, grooved band  
polished and satin-finished  
sizes 7-13, \$90



**T851**  
4.0 width, grooved band  
polished, sizes 6-12, \$90



**T954**  
7.0 width, beveled band, polished  
and hammer-finished  
sizes 6-12, \$110



**T953**  
7.0 width, beveled band  
polished and hammer-finished  
with gold IP, sizes 6-12, \$150



**T952**  
7.0 width, beveled band, polished  
and hammer-finished with  
rose IP, sizes 6-13, \$150



**T101**  
6.0 width, beveled band with  
black cable inset, polished  
sizes 6-11, \$170



**T910**  
7.0 width, sterling silver inlay  
polished and satin-finished  
sizes 8-13, \$210



**T911**  
7.0 width, sterling silver inlay  
polished and satin-finished  
sizes 8-13, \$310



**T931**

7.0 width, sterling silver inlay  
satin-finished, sizes 8-13, \$190



**T898**

7.0 width, ridged band  
with sterling silver inlay  
polished and satin-finished  
sizes 7-13, \$210



**T918**

7.0 width, flat band  
with sterling silver inlay  
polished and satin-finished  
sizes 8-13, \$190



**T917**

9.0 width, beveled band  
with sterling silver inlay  
polished and satin-finished  
sizes 8-14, \$210



**T842**

6.0 width, 14kt yellow inlay  
polished and satin-finished  
sizes 6-12.5, \$308



**T942**

7.0 width, ridged band  
with 14kt yellow inlay  
polished and satin-finished  
sizes 8-13, \$308



**T899**

7.0 width, 14kt rose inlay  
satin-finished  
sizes 8-12, \$383



**T941**

8.0 width, beveled band  
with 14kt yellow inlay  
polished and satin-finished  
sizes 8-13, \$308



**T805D**

0.05 ct, 8.0 width  
polished  
sizes 8-13, 209, \$203



**T944D**

0.05 ct, 8.0 width  
ridged band, polished  
sizes 8-13, 209, \$233



**T843**

0.05 ct, 6.0 width, grooved band  
polished and satin-finished  
sizes 7-13, 209, \$158



**T915D**

0.05 ct, 9.0 width, flat band with  
black enamel and sterling silver inlay  
satin-finished, 14kt yellow plated bezel,  
sizes 8-12, 209, \$308



**T984D**

1/10 ct tw, 8.0 width  
grooved band, polished  
sizes 8-12, 209, \$383



**T1013D**

1/8 ct tw, 5.0 width  
grooved band, polished  
sizes 6-11, 209, \$353



COBALT BANDS



**COR166**  
4.0 width, polished  
sizes 7-12, \$170



**COR167**  
6.0 width, polished  
sizes 7-13, \$170



**COR168**  
8.0 width, polished  
sizes 7-13, \$170



**COR229**  
6.0 width, flat band  
polished, sizes 7-13, \$170



**COR230**  
8.0 width, flat band  
polished, sizes 7-13, \$170



**COR188**  
6.0 width, beveled band  
polished, sizes 7-12, \$210



**COR189**  
8.0 width, beveled band  
polished, sizes 8-13, \$210



Items featured above available with finishes shown. Ice finish also available (not shown).

A. **COR168** Satin | B. **COR168** Bead Blast | C. **COR168** Stone | D. **COR168** Hammered | E. **COR168** Glass Blast



**COR152**  
6.0 width, ridged band  
polished, sizes 7-13, \$210



**COR153**  
8.0 width, ridged band  
polished, sizes 7-13, \$210



**COR155**  
6.0 width, ridged band  
polished, sizes 7-12, \$210



**COR156**  
8.0 width, ridged band  
polished, sizes 8-13, \$210



**COR225**  
5.0 width, grooved band  
polished, sizes 7-12, \$210



**COR226**  
7.0 width, grooved band  
polished, sizes 7-13, \$210



**COR236**  
8.0 width, grooved band  
polished, sizes 7-13, \$210



**COR149**  
8.0 width, grooved band  
polished and satin-finished  
sizes 7-14, \$210



**COR233**  
8.0 width, ridged band  
polished and satin-finished  
sizes 8-14, \$210



**COR224**  
7.0 width, grooved and beveled  
band, polished and satin-finished  
sizes 7-13, \$210



**COR129**  
8.0 width, grooved and beveled  
band, polished and satin-finished  
sizes 8-13, \$210



**COR132**  
6.0 width, ridged band  
polished and satin-finished  
sizes 7-14, \$210



**COR120**  
8.0 width, ridged band  
polished and satin-finished  
sizes 8-14, \$210



**COR133**  
10.0 width, ridged band  
polished and satin-finished  
sizes 9-14, \$210



**COR228**  
6.0 width, flat band  
polished and satin-finished  
sizes 7-13, \$210

## COBALT BANDS



**COR240**  
10.0 width, grooved and beveled  
casted band, polished and  
satin-finished, sizes 9-14, \$297



**COR247**  
9.0 width, ridged casted band,  
polished and oxidized  
sizes 9-14, \$372



**COR249**  
8.5 width, casted band  
polished and oxidized  
sizes 9-14, \$372



**COR250**  
7.0 width, casted band  
polished and oxidized  
sizes 9-14, \$372



**COR245**  
8.0 width, casted band  
polished and oxidized  
sizes 9-14, \$372



**COR244**  
8.0 width, casted band  
polished and blackened  
sizes 9-14, \$372



**COR251**  
8.0 width, casted band with wood  
grain center, polished and blackened  
sizes 9-14, \$291



A. COR245 | B. COR249 | C. COR250 | D. COR244



A. **COR241** | B. **COR248** | C. **COR246** | D. **COR252D**



**COR242**  
8.0 width, silver and copper  
mokume gane inlay, polished  
sizes 9-14, \$621



**COR243**  
7.5 width, grooved band  
polished and blackened  
sizes 9-14, \$300



**COR253D**  
1/2 ct tw, 7.5 width, grooved and beveled  
casted band, polished and satin-finished  
sizes 9-14, 184, \$698



**COR246**  
9.0 width, grooved casted  
band, polished and oxidized  
sizes 9-14, \$372



**COR248**  
9.0 width, grooved casted  
band, polished and oxidized  
sizes 9-14, \$372



**COR241**  
7.5 width, casted band  
polished and oxidized  
sizes 9-14, \$315



**COR252D**  
9.0 width, grooved and beveled  
casted band, polished and black-  
ened sizes 9-14, 184, \$760

## COBALT BANDS

---



### **COR202**

7.0 width, ridged band  
polished and hammer-finished  
sizes 7-12, \$210



### **COR203**

7.0 width, grooved band  
polished and hammer finished  
sizes 8-13, \$210



### **COR206**

8.0 width, beveled band  
with gray carbon fiber inlay  
polished, sizes 8-13, \$210



### **COR121**

8.0 width, beveled band  
with black carbon fiber inlay  
polished, sizes 8-13, \$210



### **COR109**

8.0 width, flat band  
with black laser pattern  
satin-finished, sizes 7-12, \$210



### **COR127**

8.0 width, flat band  
with black laser pattern  
polished, sizes 8-14, \$210



### **COR128**

8.0 width, flat band  
with black laser pattern  
polished, sizes 8-13, \$210



### **COR124**

8.0 width, beveled band with  
black laser pattern  
polished, sizes 8-13, \$210



### **COR113**

8.0 width, concave and ridged  
band with black laser pattern  
polished, sizes 8-12, \$210



### **COR122**

8.0 width, ridged band  
with black laser pattern  
polished, sizes 8-14, \$210



### **COR140**

8.0 width, double ridged band  
with black laser pattern  
polished, sizes 7-13, \$210



### **COR147**

10.0 width, double ridged band  
with black laser pattern  
polished, sizes 9-14, \$210

---

### TECHNICAL TIP: Polishing Cobalt

Although Cobalt can scratch, a jeweler can take those scratches out using these steps below.

#### **Step 1**

To remove scratches and bring finish to a pre-polish, use a felt wheel (#17-1207) with Gray Star compound (#47-3297).

Clean ring thoroughly to remove all pre-polish residue.

#### **Step 2**

To bring surface to a high mirror luster, use string buff (#17-1108) and Picasso Blue polish (#47-3246).

Clean the ring thoroughly again and it is ready to be presented to your customer.



**COR166**  
4.0 width, 14kt rose inlay  
satin-finished  
sizes 7-12, \$410



**COR166**  
4.0 width, 14kt yellow inlay  
satin-finished  
sizes 7-12, \$410



**COR167**  
6.0 width, 14kt rose inlay  
satin-finished  
sizes 7-13, \$410



**COR229**  
6.0 width, flat band with  
14kt rose inlay, satin-finished  
sizes 7-13, \$410



**COR191K**  
6.0 width, ridged band with 14kt yellow  
inlay, polished and satin-finished  
sizes 8-13, \$458



**COR192K**  
8.0 width, grooved band with 14kt yellow  
inlay, polished and satin-finished  
sizes 8-13, \$533



**COR168**  
8.0 width, 14kt yellow inlay  
satin-finished  
sizes 7-13, \$537



**COR230**  
8.0 width, flat band with  
14kt yellow inlay, satin-finished  
sizes 7-13, \$537



**COR166**  
4.0 width, Continuum™ Sterling  
Silver inlay, satin-finished  
sizes 7-12, \$155



**COR167**  
6.0 width, Continuum™  
Sterling Silver inlay  
satin-finished  
sizes 7-13, \$155



**COR168**  
8.0 width, Continuum™  
Sterling Silver inlay  
satin-finished  
sizes 7-13, \$162



**COR229**  
6.0 width, flat band with  
Continuum™ Sterling Silver inlay  
satin-finished  
sizes 7-13, \$155



**COR230**  
8.0 width, flat band with  
Continuum™ Sterling Silver inlay  
satin-finished  
sizes 7-13, \$155

## COBALT BANDS

---



**COR130D**  
0.05 ct, 8.0 width, ridged band  
polished and satin-finished  
sizes 8-13, 209, \$308



**COR215D**  
 $\frac{1}{10}$  ct, 10.0 width, polished  
sizes 8-13, 209, \$506



**COR216D**  
 $\frac{1}{6}$  ct tw, 8.0 width, polished  
sizes 8-13, 209, \$683



**COR108D**  
 $\frac{1}{10}$  ct tw, 7.0 width  
ridged band  
polished and satin-finished  
sizes 8-12, 209, \$458



**COR182D**  
 $\frac{1}{10}$  ct tw, 7.0 width,  
grooved and beveled band  
polished and satin-finished  
sizes 8-12, 209, \$506



**COR135D**  
 $\frac{1}{10}$  ct tw, 8.0 width  
grooved and beveled band  
polished and satin-finished  
sizes 8-13, 209, \$506



**COR137D**  
 $\frac{1}{6}$  ct tw, 8.0 width, ridged band  
polished and satin-finished  
sizes 8-13, 209, \$608



**COR218D**  
 $\frac{1}{6}$  ct tw, 7.0 width, grooved band  
polished and hammer-finished  
sizes 8-13, 209, \$608



**COR214D**  
 $\frac{1}{6}$  ct tw, 10.0 width, ridged band  
polished and satin-finished  
sizes 8-13, 209, \$1,007



**COR217D**  
 $\frac{1}{4}$  ct tw, 8.0 width, ridged band  
polished and satin-finished  
sizes 8-13, 209, \$1,007



**COR219D**  
 $\frac{1}{4}$  ct tw, 8.0 width, beveled band  
polished and satin-finished  
sizes 8-13, 209, \$1,007



**TAR022**  
4.0 width, polished  
sizes 6-12.5, \$288



**TAR023**  
6.0 width, polished  
sizes 6-13, \$288



**TAR003**  
8.0 width, polished  
sizes 7-14, \$288



**TAR286**  
10.0 width, polished  
sizes 8-14, \$288



**TAR022**  
4.0 width, polished band  
with white PVD  
sizes 6-12.5, \$288



**TAR023**  
6.0 width, polished band  
with white PVD  
sizes 6-13, \$288



**TAR003**  
8.0 width, polished band  
with white PVD  
sizes 7-14, \$288



**TAR286**  
10.0 width, polished band  
with white PVD  
sizes 9-14, \$288



**TAR022**  
4.0 width, polished band  
with rose PVD  
sizes 5-13, \$288



**TAR023**  
6.0 width, polished band  
with rose PVD  
sizes 5-13, \$288



**TAR023**  
6.0 width, polished band  
with black PVD  
sizes 5-13, \$288



**TAR030**  
8.0 width, polished band  
with black PVD  
sizes 7-13, \$288



**TAR262**  
6.0 width, sandblasted  
sizes 6-12, \$288



**TAR262**  
6.0 width, sandblasted  
with white PVD  
sizes 6-12, \$288



**TAR251**  
8.0 width, beveled band  
polished and satin-finished  
sizes 7-13, \$288



**TAR251**  
8.0 width, beveled band  
polished and satin-finished  
with white PVD  
sizes 8-12, \$288



## TUNGSTEN BANDS

---



**TAR221**  
6.0 width, flat band  
polished  
sizes 6-12, \$288



**TAR221**  
6.0 width, flat band  
polished with white PVD  
sizes 6-11, \$288



**TAR266**  
6.0 width, flat band  
satin-finished  
sizes 6-11.5, \$288



**TAR266**  
6.0 width, flat band  
satin-finished with white PVD  
sizes 6-11.5, \$288

---



**TAR024**  
8.0 width, flat band  
polished  
sizes 7-14, \$288



**TAR024**  
8.0 width, flat band  
polished with white PVD  
sizes 7-14, \$288



**TAR032B**  
8.0 width, flat band  
polished with black PVD  
sizes 7-13, \$288

---



**TAR035**  
6.0 width, beveled band  
polished  
sizes 7-12, \$288



**TAR035**  
6.0 width, beveled band  
polished with white PVD  
sizes 7-13, \$288



**TAR035B**  
6.0 width, beveled band  
polished with black PVD  
sizes 7-12, \$288

---



**TAR034**  
8.0 width, beveled band  
polished  
sizes 7-13, \$288



**TAR518**  
8.0 width, beveled band  
polished with white PVD  
sizes 7-13, \$288



**TAR034B**  
8.0 width, beveled band  
polished with black PVD  
sizes 7-13, \$288



**TAR105**  
6.0 width, beveled band  
polished and satin-finished  
sizes 6-12.5, \$288



**TAR105**  
6.0 width, beveled band, polished  
and satin-finished with white PVD  
sizes 6-12.5, \$288



**TAR105B**  
6.0 width, beveled band, polished  
and satin-finished with black PVD  
sizes 6-13, \$288



**TAR008**  
8.0 width, beveled band  
polished and satin-finished  
sizes 7-14, \$288



**TAR008**  
8.0 width, beveled band, polished  
and satin-finished with white PVD  
sizes 7-14, \$288



**TAR008B**  
8.0 width, beveled band, polished  
and satin-finished with black PVD  
sizes 7-13, \$288



**TAR123**  
6.0 width, grooved band  
polished  
sizes 6.5-12, \$288



**TAR123**  
6.0 width, grooved band  
polished with white PVD  
sizes 6.5-12, \$288



**TAR123**  
6.0 width, grooved band  
polished with black PVD  
sizes 6.5-12, \$288



**TAR248**  
8.0 width, beveled band  
polished and satin-finished  
sizes 7-13, \$288



**TAR248**  
8.0 width, beveled band, polished  
and satin-finished with white PVD  
sizes 7-13, \$288



**TAR259**  
10.0 width, grooved band  
polished  
sizes 8-14, \$288



**TAR259**  
10.0 width, grooved band  
polished with white PVD  
sizes 8-14, \$288

## TUNGSTEN BANDS

---



**TAR215**  
7.0 width, grooved band  
polished  
sizes 7-13, \$288



**TAR215**  
7.0 width, grooved band  
polished with white PVD  
sizes 7-13, \$288



**TAR215**  
7.0 width, grooved band  
polished with black PVD  
sizes 7-13, \$288



**TAR204**  
6.0 width, ridged band  
polished and satin-finished  
sizes 6-13, \$288



**TAR204**  
6.0 width, ridged band, polished  
and satin-finished with white PVD  
sizes 6-12, \$288



**TAR204**  
6.0 width, ridged band, polished  
and satin-finished with black PVD  
sizes 7-12, \$288



**TAR204**  
6.0 width, ridged band, polished  
and satin-finished with rose PVD  
sizes 5-13, \$288



**TAR252**  
8.0 width, ridged band  
polished and satin-finished  
sizes 7-14, \$288



**TAR252**  
8.0 width, ridged band, polished  
and satin-finished with white PVD  
sizes 7-14, \$288



**TAR252**  
8.0 width, ridged band, polished  
and satin-finished with black PVD  
sizes 7-14, \$288



**TAR252**  
8.0 width, ridged band, polished  
and satin-finished with rose PVD  
sizes 5-13, \$288



**TAR258**  
10.0 width, ridged band  
polished and satin-finished  
sizes 8-14, \$288



**TAR258**  
10.0 width, ridged band, polished and  
satin-finished with white PVD  
sizes 8-14, \$288



**TAR258**  
10.0 width, ridged band, polished and  
satin-finished with black PVD  
sizes 8-14, \$288



**TAR517**  
8.0 width, grooved band  
polished and satin-finished  
sizes 8-13, \$360



**TAR517**  
8.0 width, grooved band, polished  
and satin-finished with white PVD  
sizes 8-13, \$360



**TAR517**  
8.0 width, grooved band, polished  
and satin-finished with black PVD  
sizes 8-13, \$360



**TAR529**  
8.0 width, grooved band  
polished and satin-finished  
sizes 8-13, \$360



**TAR529**  
8.0 width, grooved band, polished  
and satin-finished with white PVD  
sizes 8-13, \$360



**TAR529**  
8.0 width, grooved band, polished  
and satin-finished with black PVD  
sizes 8-13, \$360



**TAR521**  
6.0 width, polished with  
black laser pattern  
sizes 7-13, \$360



**TAR521**  
6.0 width, polished with black  
PVD and gray laser pattern  
sizes 7-13, \$360



**TAR530**  
8.0 width, grooved and ridged  
band, polished and satin-finished  
with black and white PVD  
sizes 7-13, \$360



**TAR53**  
8.0 width, grooved and ridged  
band, polished and satin-finished  
with black and white PVD  
sizes 7-13, \$360



**TAR052**  
6.0 width, ridged band polished with  
black PVD and gray laser pattern  
sizes 7-13, \$360



**TAR345**  
6.0 width, ridged band, polished  
and satin-finished with black PVD  
sizes 6-11.5, \$360



**TAR360**  
8.0 width, polished with black  
PVD and gray laser pattern  
sizes 8-13, \$360



**TAR039**  
8.0 width, flat band, polished with  
black PVD and gray laser pattern  
sizes 8-13, \$360

## TUNGSTEN BANDS



**TAR210**  
7.0 width, ridged band polished  
sizes 7-13, \$288



**TAR210**  
7.0 width, ridged band  
polished with white PVD  
sizes 7-13, \$288



**TAR321**  
7.0 width, grooved band polished  
and satin-finished with white PVD  
sizes 6-12.5, \$288



**TAR321B**  
7.0 width, grooved band polished  
and satin-finished with black PVD  
sizes 6-12, \$288



**TAR203**  
6.0 width, polished  
and satin-finished  
sizes 7-13, \$288



**TAR203**  
6.0 width, polished and  
satin-finished with white PVD  
sizes 7-13, \$288



**TAR249**  
8.0 width, polished  
and satin-finished  
sizes 7-14, \$288



**TAR249**  
8.0 width, polished and  
satin-finished with white PVD  
sizes 8-13, \$288



**TAR239**  
8.0 width, grooved band  
polished and satin-finished  
sizes 7-12.5, \$288



**TAR239**  
8.0 width, grooved band, polished  
and satin-finished with white PVD  
sizes 7-12.5, \$288



**TAR240**  
8.0 width, grooved band  
polished and satin-finished  
sizes 7-12.5, \$288



**TAR240**  
8.0 width, grooved band, polished  
and satin-finished with white PVD  
sizes 8-12, \$288



**TAR100**  
8.0 width, flat band  
polished and satin-finished  
sizes 7-13, \$288



**TAR100**  
8.0 width, flat band  
polished and satin-finished  
with white PVD  
sizes 7-13, \$288



**TAR250**  
8.0 width, grooved band  
polished and satin-finished  
sizes 7-13, \$288



**TAR250**  
8.0 width, grooved band  
polished and satin-finished  
with white PVD  
sizes 7-13, \$288



**TAR291**  
8.0 width, grooved band  
polished and satin-finished  
sizes 8-12.5, \$288



**TAR291**  
8.0 width, grooved band, polished  
and satin-finished with white PVD  
sizes 8-12, \$288



**TAR499**  
8.0 width, ridged band  
with bark finish  
sizes 8-13, \$288



**TAR499**  
8.0 width, ridged band with  
bark finish and white PVD  
sizes 8-13, \$288



**TAR009**  
8.0 width, faceted band  
polished  
sizes 6-12, \$288



**TAR009**  
8.0 width, faceted band  
polished with white PVD  
sizes 6-12, \$288



**TAR257**  
10.0 width, concave band  
polished  
sizes 9-14, \$288



**TAR257**  
10.0 width, concave band  
polished with white PVD  
sizes 9-14, \$288



**TAR047**  
8.0 width, beveled band, polished with  
black laser cross pattern  
sizes 7-14, \$288



**TAR047**  
8.0 width, beveled band, polished with  
black laser cross pattern and white PVD  
sizes 8-13, \$288



### Tungsten Ring Cracker Kit

This tool will allow you to crack any ceramic or tungsten band with no pain to the customer. The Ring Cracker is so easy to use, anyone can assist. The kit comes with a Ring Cracker, two pairs of safety glasses, and instructions. *(Only removes tungsten and ceramic rings.)*

#58-2440

## TUNGSTEN BANDS



**TAR516**

8.0 width, ridged and grooved band, polished and satin-finished with white PVD, sizes 8-13, \$340



**TAR228**

8.0 width, grooved band polished sizes 8-12.5, \$340



**TAR247**

8.0 width, grooved band polished and satin-finished sizes 8-13, \$288



**TAR222**

8.0 width, grooved band polished and satin-finished sizes 8-12.5, \$288



**TAR326**

8.0 width, grooved and beveled band, polished and satin-finished sizes 8-13, \$288



**TAR326**

8.0 width, grooved and beveled band, polished and satin-finished with white PVD, sizes 6-12, \$288



**TAR333**

8.0 width, grooved and beveled band, polished and satin-finished sizes 8-12, \$288



**TAR253**

10.0 width, grooved and beveled band, polished sizes 7-13, \$288



**TAR209**

7.0 width, faceted and ridged band, polished sizes 6-12, \$288



**TAR224**

8.0 width, faceted band polished sizes 7-13, \$288



**TAR355**

8.0 width, faceted band polished with black resin sizes 8-12, \$340



**TAR264**

8.0 width, beveled band polished with black enamel sizes 7-13, \$288



**TAR267**

8.0 width, beveled band polished with black enamel sizes 8-12.5, \$288



**TAR269**

8.0 width polished with black enamel sizes 8-13, \$288



**TAR268**

8.0 width polished with black enamel sizes 7-13, \$288



**TAR288**  
7.0 width, band with black ceramic inlay, polished sizes 7-12, \$340



**TAR383**  
8.0 width, band with black ceramic inlay, polished sizes 8-12, \$288



**TAR341**  
8.0 width, ridged band with black ceramic overlay, polished and satin-finished, sizes 7-12.5, \$288



**TAR342**  
8.0 width, beveled band with black ceramic overlay, polished and satin-finished, sizes 8-12, \$288



**TAR373**  
6.0 width, band with black ceramic inlay, polished sizes 6-11, \$320



**TAR127**  
8.0 width, band with black carbon fiber inlay, polished sizes 7-12.5, \$340



**TAR276**  
8.0 width, beveled band with black carbon fiber inlay, polished sizes 7-14, \$340



**TAR276**  
8.0 width, beveled band with black carbon fiber inlay, polished with white PVD, sizes 7-14, \$340



**TAR358**  
8.0 width, beveled band with gray carbon fiber inlay, polished sizes 7-12, \$340



**TAR359**  
8.0 width, beveled band with gold carbon fiber inlay, polished sizes 7-12, \$340



**TAR543**  
6.0 width, ridged band polished and satin-finished with woodland camo inlay, sizes 5-13, \$340



**TAR543**  
8.0 width, ridged band polished and satin-finished with woodland camo inlay, sizes 8-13, \$340



**TAR543**  
6.0 width, ridged band, polished and satin-finished with desert camo inlay sizes 5-13, \$340



**TAR543**  
8.0 width, ridged band, polished and satin-finished with desert camo inlay sizes 8-13, \$340



**TAR544**  
8.0 width, beveled band polished with desert camo inlay sizes 8-13, \$340



## TUNGSTEN BANDS



**TAR395**  
6.0 width, sterling silver inlay  
polished and satin-finished  
sizes 7-11, \$420



**TAR397**  
6.0 width, sterling silver inlays  
polished and satin-finished  
sizes 7-12, \$420



**TAR387**  
6.0 width, flat band with  
sterling silver inlays, polished  
sizes 7-12, \$420



**TAR409**  
8.0 width, flat band with sterling  
silver inlays, polished and  
satin-finished, sizes 9-12, \$420



**TAR390**  
6.0 width, grooved band with  
sterling silver inlay, polished and  
satin-finished, sizes 6-12, \$420



**TAR296**  
8.0 width, beveled band with  
sterling silver inlay, polished  
sizes 7-13, \$420



**TAR297**  
6.0 width, sterling silver inlay  
polished and Swiss cut  
sizes 7-12, \$420



**TAR298**  
8.0 width, sterling silver inlays  
polished and Swiss cut  
sizes 7-12, \$500



**TAR429**  
6.0 width, 14kt yellow  
satin-finished  
sizes 7-11, \$570



**TAR441**  
8.0 width, 14kt rose  
polished and satin-finished  
sizes 8-12, \$570



**TAR438**  
8.0 width, beveled band with 14kt  
yellow, polished and satin-finished  
sizes 8-12, \$465



**TAR436**  
8.0 width, beveled band with 14kt  
yellow, polished and satin-finished  
sizes 8-12, \$465



**TAR427**  
6.0 width, grooved band  
with 14kt yellow, polished  
sizes 7-11, \$359



**TAR470**  
6.0 width, ridged band with 14kt yellow  
polished and satin-finished  
sizes 7-11, \$525



**TAR463**  
8.0 width, black antiqued band with  
14kt yellow, polished and satin-finished  
sizes 8-12.5, \$615



A. **TAR538** | B. **TAR540** | C. **TAR537** | D. **TAR541** | E. **TAR536** | F. **TAR539**



**TAR536** Tungsten  
8.0 width, 10kt yellow inlay  
polished and satin-finished  
sizes 8-12, \$675



**TAR537** Tungsten  
8.0 width, 10kt yellow inlay  
polished and satin-finished  
sizes 8-13, \$675



**TAR538** Tungsten  
8.0 width, grooved band with 10kt  
yellow inlay, polished and satin-finished  
sizes 8-12, \$675



**TAR539** Tungsten  
8.0 width, 10kt yellow inlay  
polished and hammer finished  
sizes 8-12, \$675



**TAR540** Tungsten  
8.0 width, 10kt yellow inlay  
polished and satin-finished  
sizes 8-12, \$675



**TAR541** Tungsten  
8.0 width, 10kt rose inlay  
polished and Swiss cut finished  
sizes 8-12, \$675

## TUNGSTEN BANDS



**TAR495D**  
0.05 ct, 8.0 width  
ridged and grooved band  
polished and satin-finished  
sizes 8-12.5, 209, \$414



**TAR495D**  
0.05 ct, 8.0 width, ridged  
and grooved band, polished and  
satin-finished with white PVD  
sizes 8-12, 209, \$414



**TAR495D**  
0.05 ct, 8.0 width, ridged  
and grooved band, polished and  
satin-finished with white PVD  
sizes 8-12, 184, \$414



**TAR495D**  
0.05 ct, 8.0 width, ridged  
and grooved band, polished and  
satin-finished with black PVD  
sizes 8-12, 209, \$414



**TAR482D**  
0.05 ct, 8.0 width, beveled band  
polished and satin-finished  
sizes 8-13, 209, \$414



**TAR482D**  
0.05 ct, 8.0 width, beveled band  
polished and satin-finished  
with white PVD  
sizes 8-13, 209, \$414



**TAR482D**  
0.05 ct, 8.0 width, beveled band  
polished and satin-finished  
with white PVD  
sizes 8-13, 184, \$414



**TAR512D**  
0.05 ct, 8.0 width  
grooved and beveled band  
polished and satin-finished  
sizes 8-12, 209, \$465



**TAR512D**  
0.05 ct, 8.0 width, grooved  
and beveled band, polished and  
satin-finished with white PVD  
sizes 8-12.5, 209, \$465



**TAR478D**  
0.05 ct, 8.0 width  
grooved and beveled band  
polished and satin-finished  
sizes 8-12.5, 209, \$414



**TAR478D**  
0.05 ct, 8.0 width, grooved and beveled  
band, polished and  
satin-finished with white PVD  
sizes 8-12.5, 209, \$414



**TAR497D**  
0.05 ct, 8.0 width, ridged band  
with black carbon fiber inlay  
polished and satin-finished  
sizes 8-12.5, 209, \$414



**TAR497D**  
0.05 ct, 8.0 width, ridged band  
with black carbon fiber inlay,  
polished and satin-finished with white PVD  
sizes 8-12.5, 209, \$414



**TAR445D**  
0.05 ct, 8.0 width  
beveled band with black  
carbon fiber inlay, polished  
sizes 8-13, 209, \$359



**TAR445D**  
0.05 ct, 8.0 width, beveled band  
with black carbon fiber inlay, pol-  
ished with white PVD  
sizes 8-13, 184, \$359



**TAR502D**  
0.05 ct, 8.0 width  
black ceramic inlay  
polished  
sizes 8-12, 209, \$465



**TAR514D**  
0.05 ct, 8.0 width  
black ceramic inlay  
polished and satin-finished  
sizes 8-12, 184, \$465



**TAR513D**  
1/10 ct tw, 8.0 width  
black ceramic inlay  
polished and satin-finished  
sizes 8-12, 184, \$675



**TAR508D**  
1/10 ct tw, 8.0 width  
beveled band with black enamel  
polished and satin-finished  
sizes 8-12, 209, \$570



**TAR498D**  
1/10 ct tw, 8.0 width  
ridged band  
polished and bark finish  
sizes 8-13, 209, \$615

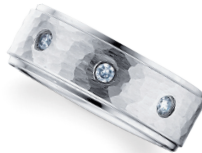

**TAR498D**  
1/10 ct tw, 8.0 width, ridged band  
polished and bark finish  
with white PVD  
sizes 8-13, 209, \$615



**TAR498D**  
1/10 ct tw, 8.0 width, ridged band  
polished and bark finish  
with white PVD  
sizes 8-13, 184, \$615



**TAR507D**  
1/10 ct tw, 8.0 width, ridged band  
polished and satin-finished  
sizes 9-12, 209, \$570



**TAR283D**  
1/8 ct tw, 8.0 width  
beveled band  
polished and satin-finished  
sizes 6-14, 209, \$714



**TAR282D**  
1/8 ct tw, 8.0 width  
grooved and beveled band  
polished and satin-finished  
sizes 8-12.5, 209, \$714



**TAR479D**  
1/8 ct tw, 8.0 width  
grooved and ridged band  
polished and satin-finished  
sizes 9-12.5, 209, \$870